

Keep With Operator's Manual

RHINO 3109 LOADER MOUNTING KIT NEW HOLLAND TRACTORS

MODEL	2WD	ROPS
TT45A	X	X
TT50A	X	X

TRACTOR AND MOUNTING KIT GENERAL INFORMATION

NOTE: Loader is not compatible with narrowest tread setting. Refer to tractor operator's manual for adjustment procedures.

Mounting kit can be installed on tractor using tools ordinarily available. For tractors with a toolbox, it will be necessary to relocate it to right mount upright.

Shut off engine, remove key and engage brakes during installation.

NOTE: Install all attaching hardware loosely (unless noted otherwise) until mounting kit is completely assembled to facilitate assembly and proper alignment. Tighten all hardware to torques specified in general torque specifications table included in the loader operator's manual.

REMOVING LOADER FROM PALLET (Figure 1)

1. Loop chain under each tilt cylinder and hook on loader boom arm. Using overhead hoist to support loader, remove hardware which secures loader and mounts to pallet. Lift loader and remove pallet.
2. Using overhead hoist, lower loader and mounts from vertical shipping position to horizontal. Lower loader completely to ground.

INSTALLING MOUNTING BRACKETS (Figure 2)

1. Remove two bolts holding platform to clutch housing on the left side of the tractor. Remove all ten plastic plugs and clean threads with a thread chaser and lube.



Warning: Using bolts longer than 120mm in lower transmission mounting holes could cause damage to housing.

2. Attach left mount bracket (2) to left side of tractor transmission housing using six 16mm-1.5 x 120mm cap screws (4), 5/8" flat washers (8), and 5/8" lock washers (7).

Figure 1

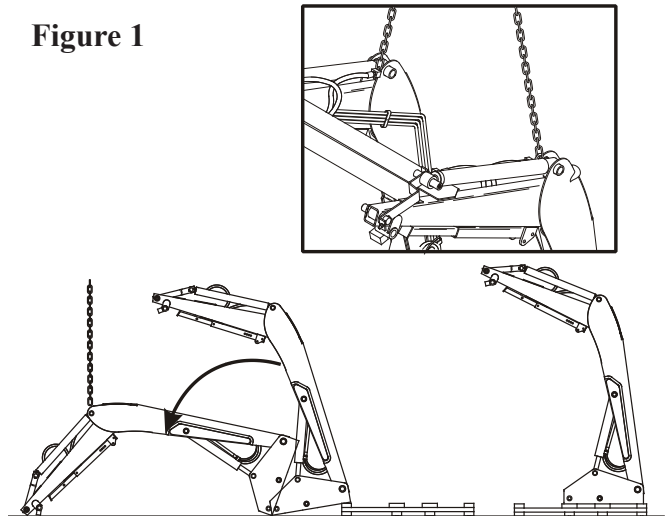

3. Attach left mount bracket (2) to left side of tractor front bolster using a 16mm-1.5 x 80mm cap screw (5), 5/8" flat washer (8), and 5/8" lock washer (7) in the back two holes. Position grille guard (3) up to front two holes in mount. Use 16mm-1.5 x 90mm cap screws (6), 5/8" flat washers (8), and 5/8" lock washers (7) in front two holes.
4. Remove toolbox if equipped. Remove two bolts holding platform to clutch housing on the right side of the tractor. Remove all ten plastic plugs and clean threads with a thread chaser and lube.
5. Slide right mount bracket (1) into place. Attach right mount bracket (1) to right side of tractor transmission housing using six 16mm-1.5 x 120mm cap screws (4), 5/8" flat washers (8), and 5/8" lock washers (7).
6. Attach right mount bracket (1) to right side of tractor front bolster using a 16mm-1.5 x 80mm cap screw (5), 5/8" flat washer (8), and a 5/8" lock washer (7) in the back two holes. Position grille guard (3) up to front two holes in mount. Use 16mm-1.5 x 90mm cap screws (6), 5/8" lock washers (7), and 5/8" flat washers (8) in front two holes.
7. Leave mount hardware loose until loader is installed.
8. Attach toolbox to right mount bracket (1) using 5/8"-11 x 1.25" cap screw (9), and 5/8"-11 nut (10).

INSTALLING LOADER TO MOUNTING BRACKETS

- Using overhead hoist and nylon straps raise loader boom and position it up to the mount uprights. Attach loader boom to right and left mount bracket (1 & 2) using hitch pin provided with loader.
- Tighten all hardware to torques specified in general torque specifications table. Torque 16mm-1.5 hardware to 130 ft. lbs. Re-torque all hardware after 10 hours of use and after every 50 hours of use.
- Install valve kit to tractor and loader. Refer to assembly instructions provided with valve kit for instructions.
- Refer to operators manual for bucket level indicator installation instructions.
- Oscillate axle and check tire clearances with lift cylinders fully retracted.

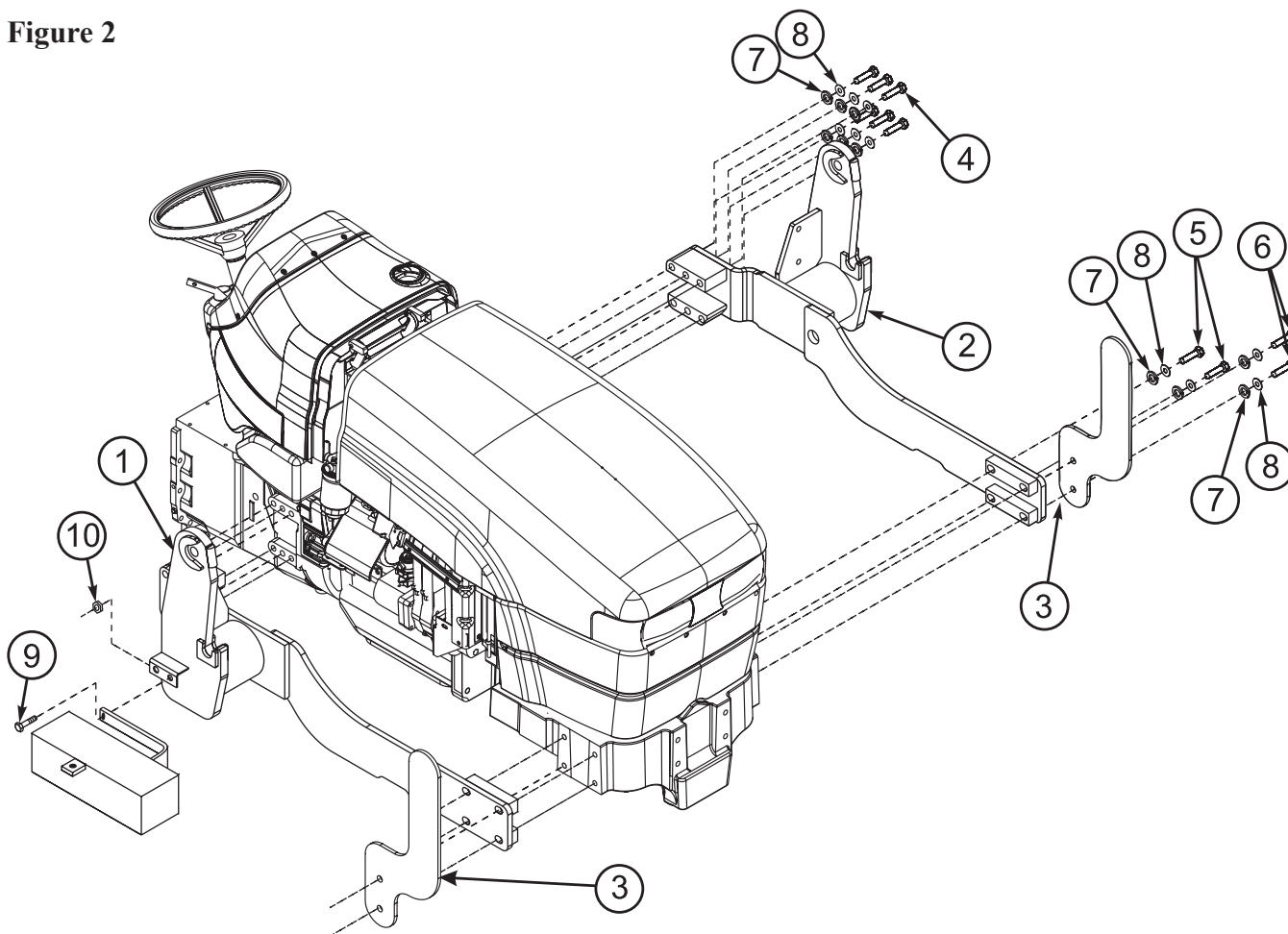
Figure 2**PARTS LIST - MOUNTING KIT**

Item	Part No.	Description	Qty.
1	54896	WDMT, MID MOUNT 3109-RIGHT	1
2	54897	WDMT, MID MOUNT 3109-LEFT	1
3	53618	GRILLE GUARD	2
4	42672-100	16MM-1.5 X 120 MM CLASS 8.8 HHCS YDP	12
5	42672-99	16MM-1.5 X 80MM CLASS 8.8 HHCS YDP	4
6	42672-74	16MM-1.5 X 90MM, CLASS 8.8 HHCS YDP	4
7	41837-7	LOCK WASHER, 5/8"	20
8	42502-12	FLAT WASHER, 5/8"	20
9	41838-3	HHCS, 5/8"-11 X 1.25 GRADE 5 YDP	1
10	41836-7	HEX NUT, 5/8"-11 YDP	1

* **NOTE:** *Parts included with Loader.*

GENERAL TORQUE SPECIFICATIONS

USE THE FOLLOWING TORQUES WHEN SPECIAL TORQUES ARE NOT GIVEN

Standard American and Metric Cap Screws

AMERICAN STANDARD CAP SCREWS									METRIC CAP SCREWS								
SAE Grade	5				8				Metric Class	8.8				10.9			
Typ. Head Markings									Typ. Head Markings								
Cap Screw	TORQUE				TORQUE				Cap Screw	TORQUE				TORQUE			
Size	FT-LBS		N-m		FT-LBS		N-m		Size	FT-LBS		N-m		FT-LBS		N-m	
Inches	MIN	MAX	MIN	MAX	MIN	MAX	MIN	MAX	Millimeters	MIN	MAX	MIN	MAX	MIN	MAX	MIN	MAX
1/4 - 20	6.25	7.25	8.5	10	8.25	9.5	11	13	M6 x 1.00	6	8	8	11	9	11	12	15
1/4 - 28	8	9	11	12	10.5	12	14	16	M8 x 1.25	16	20	21.5	27	23	27	31	36.5
5/16 - 18	14	15	19	20	18.5	20	25	27	M10 x 1.50	29	35	39	47	42	52	57	70
5/16 - 24	17.5	19	23	26	23	25	31	34	M12 x 1.75	52	62	70	84	75	91	102	123
3/8 - 16	26	28	35	38	35	37	47.5	50	M14 x 2.00	85	103	115	139	120	146	163	198
3/8 - 24	31	34	42	46	41	45	55.5	61	M16 x 2.50	130	158	176	214	176	216	238	293
7/16 - 14	41	45	55.5	61	55	60	74.5	81	M18 x 2.50	172	210	233	284	240	294	325	398
7/16 - 20	51	55	69	74.5	68	75	92	102	M20 x 2.50	247	301	335	408	343	426	465	577
1/2 - 13	65	72	88	97.5	86	96	116	130	M22 x 2.50	332	404	450	547	472	576	639	780
1/2 - 20	76	84	103	114	102	112	138	152	M24 x 3.00	423	517	573	700	599	732	812	992
9/16 - 12	95	105	129	142	127	140	172	190	M27 x 3.00	637	779	863	1055	898	1098	1217	1488
9/16 - 18	111	123	150	167	148	164	200	222	M30 x 3.00	872	1066	1181	1444	1224	1496	1658	2027
5/8 - 11	126	139	171	188	168	185	228	251	<p>NOTE: These values apply to fasteners as received from supplier, dry or when lubricated with normal engine oil. They do not apply if special graphite or moly sulphide greases or other extreme lubricants are used.</p>								
5/8 - 18	152	168	206	228	203	224	275	304									
3/4 - 10	238	262	322	355	318	350	431	474									
3/4 - 16	274	305	371	409	365	402	495	544									
7/8 - 9	350	386	474	523	466	515	631	698									
7/8 - 14	407	448	551	607	543	597	736	809									
1 - 8	537	592	728	802	716	790	970	1070									
1 - 14	670	740	908	1003	894	987	1211	1337									

INSTALLATION INSTRUCTIONS