

Keep with Operator's Manual

**GRILLE GUARD
CASE IH AND NEW HOLLAND TRACTORS**

CASE IH MODELS	NEW HOLLAND MODELS
JX1080U, JX1090U, JX1100U	TL80A, TL90A, TL100A

TRACTOR AND GRILLE GUARD GENERAL INFORMATION

Grille guard can be installed on tractor using tools ordinarily available, including standard and metric wrenches and a torque wrench.

Grille guard is not compatible with tractor front weights. If tractor is equipped with front weights, remove them before installing grille guard. It is not necessary to remove weight bracket.

Grille guard is designed to be compatible with Alamo SMC or Rhino 2410 or 5211 loaders. If loader is to be installed, install grille guard while installing loader mounting brackets.

Reference to left and right used in these instructions refer to position when seated in operating position on tractor.

Shut off engine and engage brakes during installation.

INSTALLING GRILLE GUARD (Figure 1)

NOTE: Leave all attaching hardware loose until grille guard is completely assembled to facilitate assembly and proper alignment. When grille guard is completely assembled, tighten all hardware to torques specified.

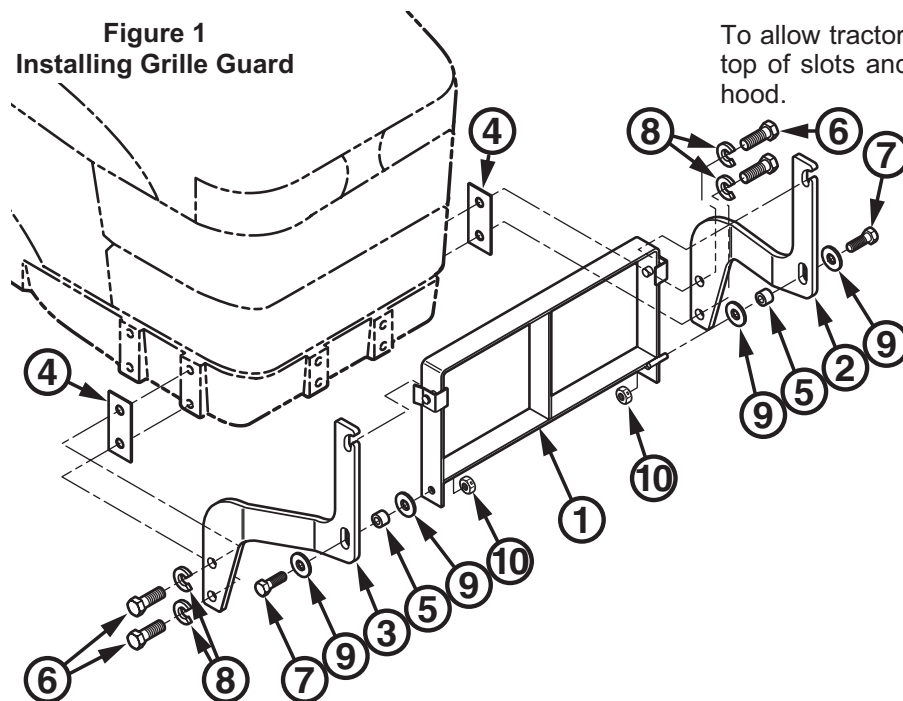

- Placing spacer (4) between left grille guard support bracket (2) and left side of tractor front casting, fasten left support bracket (2) and spacer (4) to left side of tractor using 20mm x 50mm cap screws (6) and lock washers (8). Repeat procedure to fasten right grille guard support bracket (3) and spacer (4) to right side of tractor front casting.

NOTE: Grille guard support brackets (2 & 3) bend inward toward tractor centerline.

NOTE: When mounting grille guard with loader, do not use front-most pair of spacers provided with loader mounting kit. (Space is taken up by grille guard support brackets [2 & 3] and spacers [4]). Do not use 20mm x 50mm cap screws (6) provided with this kit. Instead, use hardware provided with loader mounting kit.

- Attach grille guard (1) to grille guard support brackets (2 & 3) using 1/2 x 1-1/2" cap screws (7), flat washers (9), spacer tubes (5) and lock nuts (10).
- Torque 20mm-2.50 class 8.8 hardware to 270 ft.-lbs. (366Nm) and torque 1/2-13 Grade 5 hardware to 70ft.-lbs. (94Nm).

OPENING TRACTOR HOOD

To allow tractor hood to be opened, lift grille guard to top of slots and tilt guard forward, away from tractor hood.

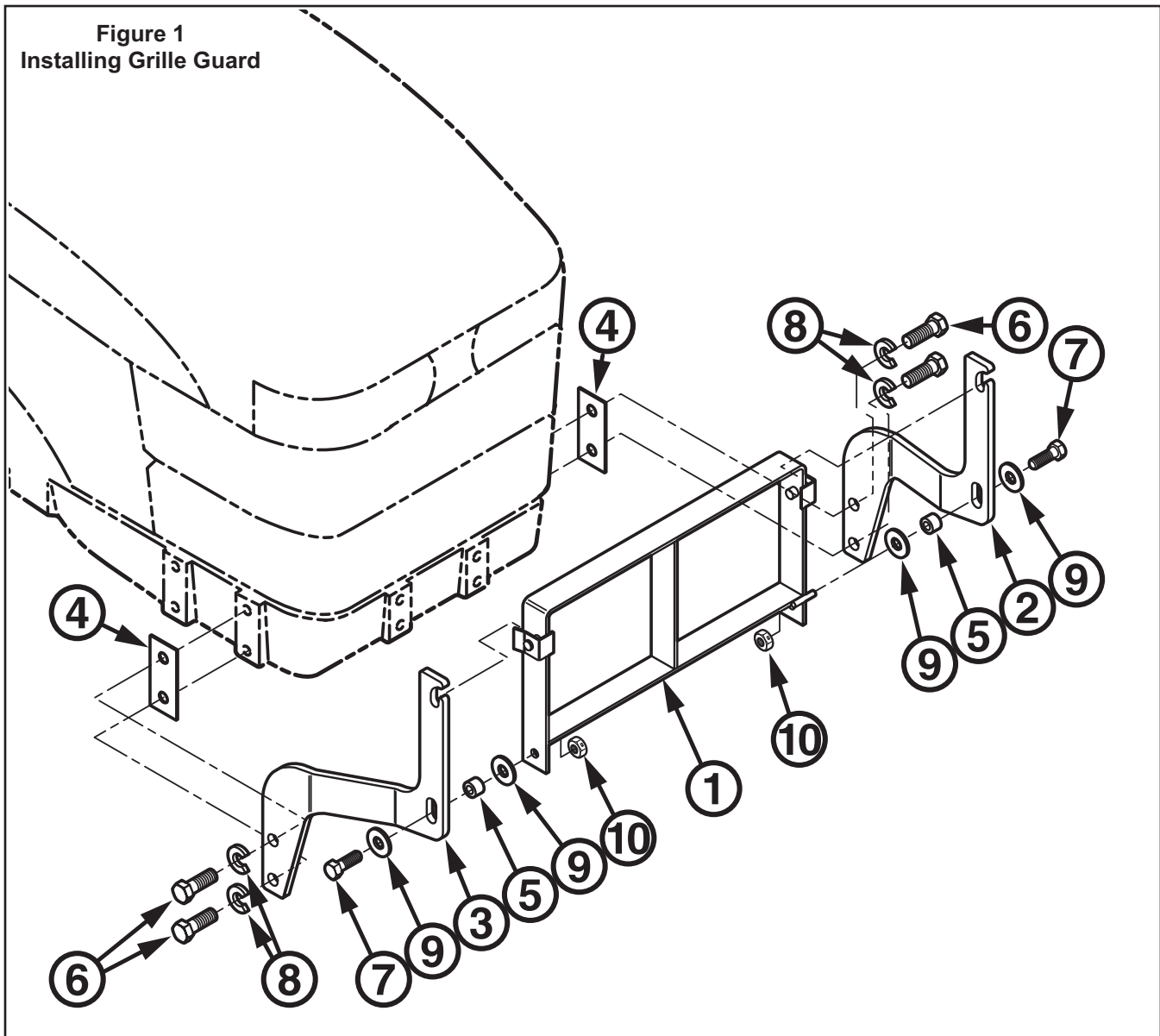

PARTS LIST - GRILLE GUARD

Item	Part No.	Description	Qty.
1	47420	GRILLE GUARD	1
2	52842-1	BRACKET, Grille Guard Support, Left	1
3	52842-2	BRACKET, Grille Guard Support, Right	1
4	52817	SPACER, Plate	2
5	47427-1	SPACER, Tube	2
6	42672-37	SCREW, Cap, 20mm-2.50 x 50mm	4
7	41838-33	SCREW, Cap, 1/2-13 x 1.50", Grade 5	2
8	48093-2	WASHER, Lock, 20mm, Grade 8.8	4
9	42502-30	WASHER, Flat, 1/2	4
10	41840-5	NUT, Lock, 1/2-13	2

INSTALLATION INSTRUCTIONS