

Keep with Operator's Manual

GRILLE GUARD NEW HOLLAND TC30 TRACTOR

TRACTOR

TC30

TRACTOR AND GRILLE GUARD GENERAL INFORMATION

Grille guard can be installed on tractor using tools ordinarily available, including standard wrenches and a torque wrench.

Grille guard can be used on tractors with or without front weights.

Grille guard is designed to be compatible with Alamo SMC or Rhino 2408 loader, or New Holland 702D front blade. If loader or front blade is to be installed, install grille guard while installing front mounting brackets.

Shut off engine and engage brakes during installation.

INSTALLING GRILLE GUARD (Figure 1)

NOTE: Install all attaching hardware loosely (unless noted otherwise) until grille guard is completely assembled to facilitate assembly and proper alignment.

Support grille guard (1) at front of tractor and fasten grille guard (1) to sides of tractor front frame using 1/2 x 1-3/4" cap screws (2) and lock nuts (4).

NOTE: If tractor is equipped with a front blade, support front of blade rear frame and use 1/2 x 2-1/4" cap screws (3) in place of 1/2 x 1-3/4" cap screws (2) to fasten grille guard and blade front hanger brackets to tractor frame. (Refer to front blade operator's manual.)

Tighten 1/2-13 Grade 5 hardware to 65-72 ft.·lbs. (88-97.5 N·m) of torque.

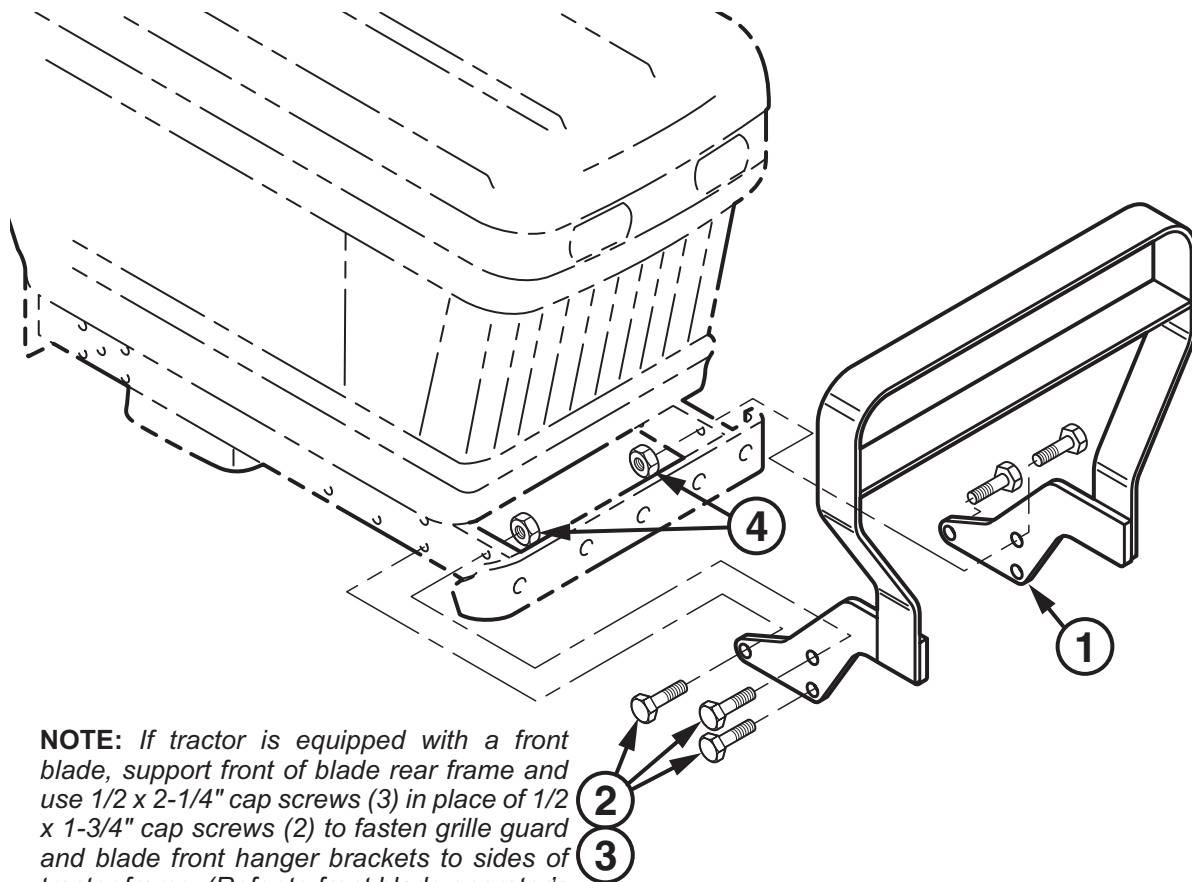

NOTE: If tractor is equipped with a front blade, support front of blade rear frame and use 1/2 x 2-1/4" cap screws (3) in place of 1/2 x 1-3/4" cap screws (2) to fasten grille guard and blade front hanger brackets to sides of tractor frame. (Refer to front blade operator's manual.)

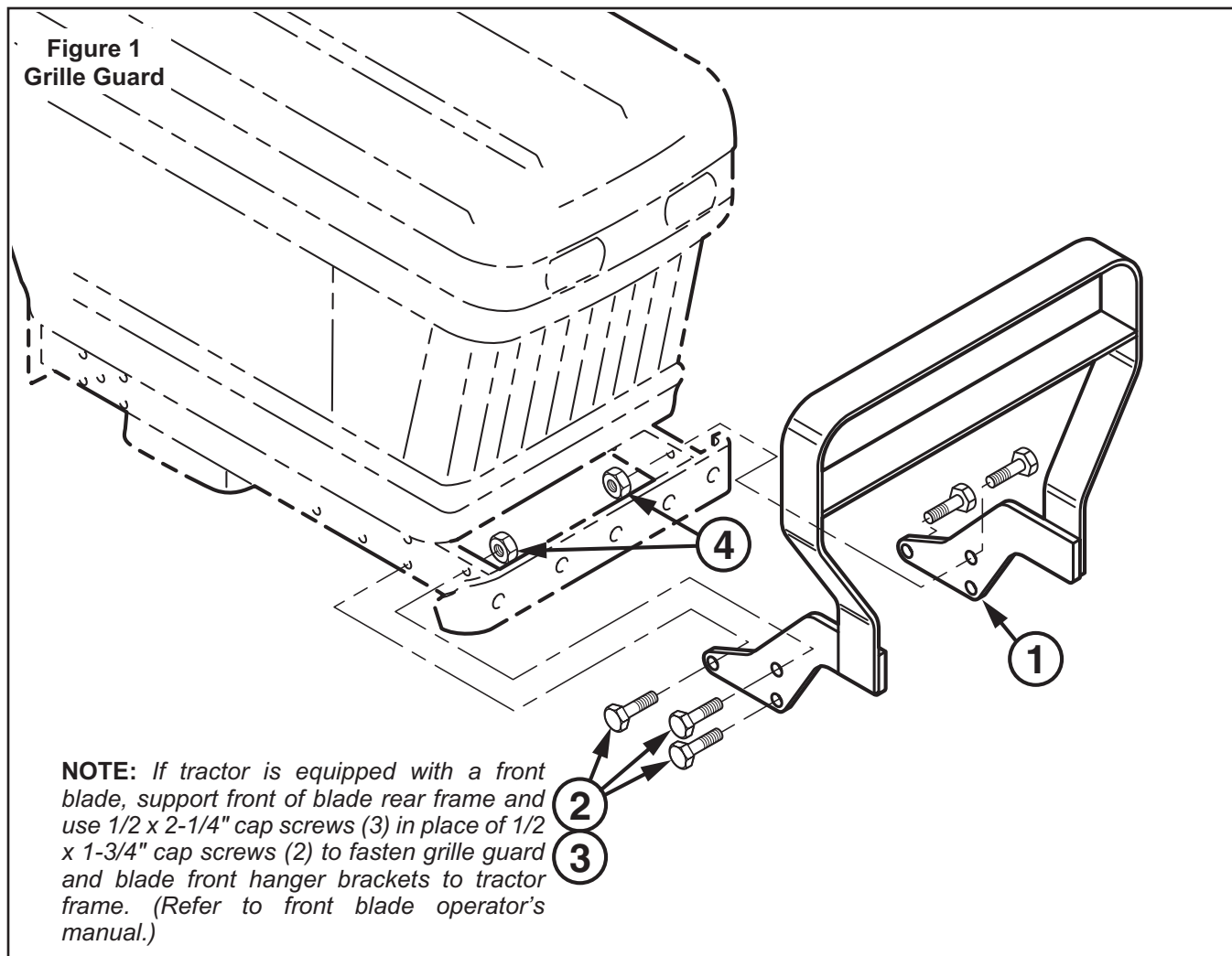

PARTS LIST – GRILLE GUARD

Item	Part No.	Description	Qty.
1	52742	GRILLE GUARD	1
2	41838-12	SCREW, Cap, 1/2-13 x 1-3/4", Grade 5	6
3	41838-18	SCREW, Cap, 1/2-13 x 2-1/4", Grade 5	6
4	41840-5	NUT, Lock, 1/2-13, Type N	6

INSTALLATION INSTRUCTIONS