

Keep with Operator's Manual

HOSE KIT 2406TL LOADER CASE IH & NEW HOLLAND TRACTORS

CASE IH MODEL	NEW HOLLAND MODEL	FWA	ROPS
DX21, DX23	TC21DA, TC23DA	X	X
DX24, DX26	TC24DA, TC26DA	X	X

GENERAL INFORMATION

Tractor must be equipped with CNH mid-mounted two-spool loader valve 715429026 to use this hose kit.

Hose kit can be installed using tools ordinarily available. Shut off engine and engage brakes during installation.

NOTE: Apply sealant only to all tapered threads unless coupled with swivel adapters. When using teflon tape, wrap tape clockwise (as viewed from end) and wrap only twice. Keep sealant away from first two threads of tapered end to prevent contamination of hydraulic fluid. Do not use sealant on o-ring or flare adapter threads



WARNING: Escaping hydraulic fluid under pressure can penetrate skin causing serious injury.

- **DO NOT** use your hands to check for leaks. Use a piece of cardboard or paper to search for leaks.
- Stop engine and relieve pressure before connecting or disconnecting lines.
- Tighten all connections before starting engine or pressurizing lines.

If any fluid is injected into skin, obtain medical attention immediately or gangrene may result.

PLUMBING LOADER TO MID MOUNTED TRACTOR VALVE (Figure 1)

1. Install 5/8" color coded spiral bands (7, 8, 9 & 10) onto female quick couplers, located at right front of tractor (supplied with CNH valve kit).

NOTE: Be sure to attach color-coded identification bands (7, 8, 9 & 10) in sequence shown in Figure 1.

2. Install 1/4" x 40" hoses (2) onto boom oil line tubes. Install and tighten hose fittings one at a time from bottom up.
3. Install 5/8" color coded spiral bands (7, 8, 9 & 10) onto free ends of hoses (2) to match bands on female quick couplers, located at right front of tractor. Slide one nylon sleeve (4) over upper two hoses (2) and slide one nylon sleeve (4) over lower two hoses (2).
4. Install 9/16-18 JIC male end of 90° elbow (3) onto each female end of 1/4" x 40" hoses (2). Install male quick couplers (1) and dust caps (6) onto free end of each 90° elbow (3).
5. Connect hoses from upper two boom oil lines to two upper female quick couplers on tractor. Connect hoses from lower two boom oil lines to two lower female quick couplers on tractor. Wrap plastic straps (5) around hoses in sleeves to secure hoses.

NOTE: Be sure color-coded identification bands are in sequence shown in Figure 1.

6. After all plumbing has been completed and all parts are secure, start tractor engine. Slowly cycle lift and tilt cylinders several times to purge any air from hydraulic system, then retract cylinders and shut off tractor engine. Add additional tractor hydraulic fluid as specified in tractor operator's manual to bring fluid level up to full.

NOTE: When cycling the loader, if direction of control lever is wrong, recheck hose connections.

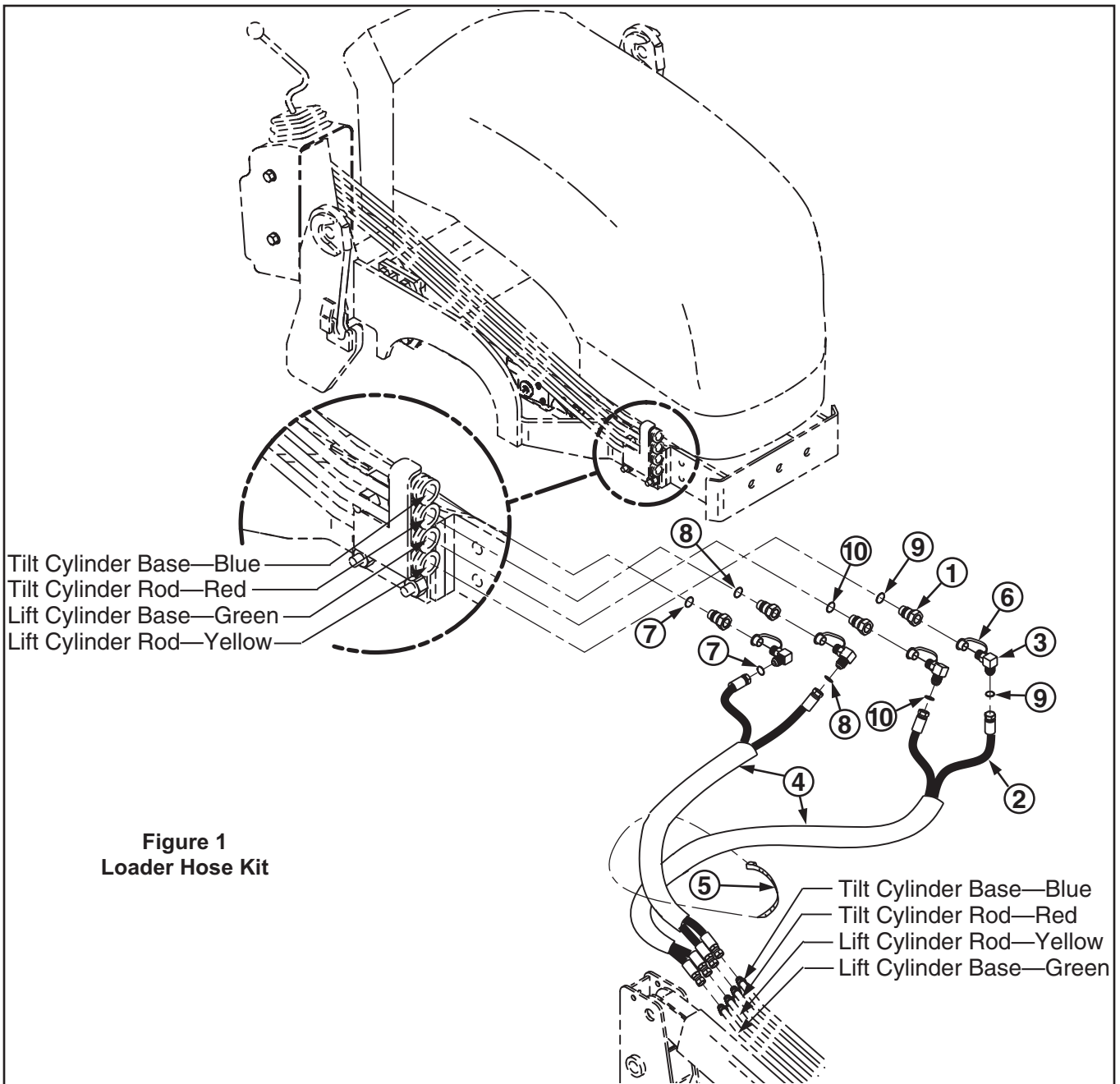

PARTS LIST – LOADER HOSE KIT

Item	Part No.	Description	Qty.
1	6137-11	COUPLER, Quick, Male	4
2	32837-9	HOSE, 1/4 x 40"	4
3	32845-1	FITTING, Elbow, 9/16-18 JIC x 9/16-18 O-Ring	4
4	34853-77	NYLON SLEEVE, 1-19/32 x 40"	2
5	8137-3	STRAP, Adjustable, 1/2 x 20"	2
6	4838-18	DUST COVER, Black	4
7	36240-5	SPIRAL BAND, Blue, 5/8"	2
8	36240-6	SPIRAL BAND, Red, 5/8"	2
9	36240-7	SPIRAL BAND, Yellow, 5/8"	2
10	36240-8	SPIRAL BAND, Green, 5/8"	2