

Keep With Operator's Manual

McCORMICK TWO FUNCTION HOSE KIT TRACTOR REAR REMOTE VALVE TO MID-MOUNT BULKHEAD, 5211 LOADER

MODEL	FWD	2 WD
MC120	X	X
MC135	X	X

HOSE KIT GENERAL INFORMATION

Hose kit can be installed on tractor and loader using tools ordinarily available. Shut off engine, engage brakes, and remove key. Check for proper tractor valve operation before plumbing loader to tractor during installation.

IMPORTANT: Check for proper tractor operator's manual for instructions.

NOTE: Apply sealant only to all tapered threads unless coupled with swivel adapters. When using teflon tape, wrap tape clockwise (as viewed from end) and wrap only twice. Keep sealant away from first two threads of tapered end to prevent contamination of hydraulic fluid. Do not use sealant on o-ring or flare adapter fittings.



WARNING: Escaping hydraulic fluid under pressure can penetrate the skin causing serious injury.

- DO NOT use your hand to check for leaks. Use a piece of cardboard or paper to search for leaks
- Stop engine and relieve pressure before starting engine or pressurizing lines.
- If any fluid is injected into skin, obtain medical attention immediately or gangrene may result.
- Tighten all connections before starting engine or pressurizing hydraulic lines.

PLUMBING TWO FUNCTION KIT TO REAR REMOTE VALVE (Figures 1, 2 & 3)

1. Install mid mount coupling bracket (4) onto right mid mount with four 5/16 x 3/4 cap screws (5) and lock nuts (6). Assemble four hoses (19) and dust plugs (11, 13, 14, & 20) to four female couplers (2). Install snap rings (3) in first groove on hose side of female couplings (2).
2. Slide female coupler (2) attached to hose (19) with yellow plug (13) into mid mount coupling bracket (4) position 1 from the bottom side of bracket (4) and attach using snap ring (3).

Couplings should occupy first four holes in bracket (4) moving from left to right when facing bracket (See figure 1). Connect male coupler (15) and yellow spiral band (24) to opposite end of hose (19) and route to tractor rear remote.

Attach male coupler to top port of first section of rear remote as illustrated in figure 2.

3. Slide female coupler (2) attached to hose (19) with green plug (14) into mid mount coupling bracket (4) position 2 from the bottom side of bracket (4) and attach using snap ring (3). Connect male coupler (15) and green spiral band (25) to opposite end of hose (19) and route to tractor rear remote. Attach male coupler to bottom port of first section of rear remote.
4. Slide female coupler (2) attached to hose (19) with blue plug (20) into mid mount coupling bracket (4) position 3 from the bottom side of bracket (4) and attach using snap ring (3). Connect male coupler (15) and blue spiral band (22) to opposite end of hose (19) and route to tractor rear remote. Attach male coupler to top port of second section of rear remote.
5. Slide female coupler (2) attached to hose (19) with red plug (11) into mid mount coupling bracket (4) position 4 from the bottom side of bracket (4) and attach using snap ring (3). Connect male coupler (15) and red spiral band (23) to opposite end of hose (19) and route to tractor rear remote. Attach male coupler to bottom port of second section of rear remote as illustrated in figure 2.
6. Using adjustable plastic straps (16), bundle hoses (19) together to avoid interference with moving parts.
7. Attach hoses (18) to oil lines beginning with bottom oil line and tighten. Mark opposite end of each hose (18) to identify color. Slide hoses through nylon sleeve (7). Loosely attach 45° fittings (1), color coded dust caps (8,9,10 & 12) and male couplers (15) as illustrated in figure 2.
8. Insert male couplers (15) into female couplers (2) making sure that colors correspond.

2-7368

NOTE: It is important to make sure color coding corresponds between dust caps and plugs on each hose.

9. Tighten 45° fittings (1) to hoses (18) and male couplers to 45° fittings (1). Punch holes through nylon sleeve near each end of sleeve, using adjustable plastic straps (17), secure nylon sleeve (7) to hoses (18) by running adjustable strap (17) through holes and around sleeve to avoid slippage and interference with moving parts.
10. Attach hoses (18) and nylon sleeve (7) to tractor hand rail with tie strap (21) as illustrated in figure 3.
11. After all plumbing has been completed slowly cycle loader several times to purge air from hydraulic system. Retract cylinders and shut off engine. Replenish tractor hydraulic system.

NOTE: When cycling loader functions, operate loader according to operation decal for valve. If direction of control lever is wrong, reverse hose connections and recheck operation.



WARNING: Escaping fluid under pressure can penetrate skin causing serious personal injury.

- Do not use your hands to check for leaks. Use a piece of cardboard or paper. Always wear eye protection when searching for leaks.
- Stop engine and relieve pressure before connecting and disconnecting lines.
- Tighten all connections before starting engine or pressurizing lines.
- If any fluid is injected into skin, obtain medical attention immediately or gangrene may result.

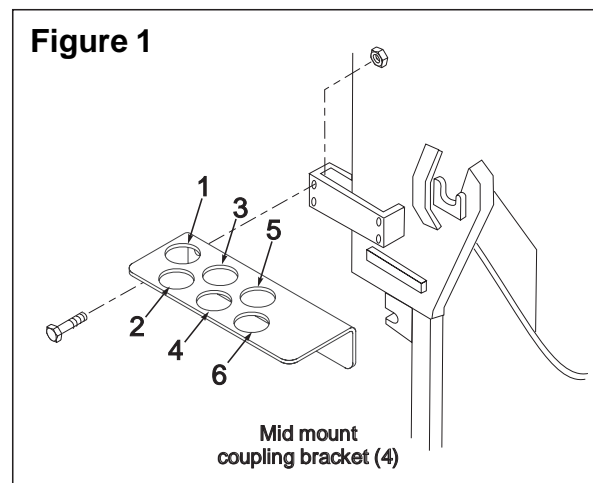

PARTS LIST - TWO FUNCTION PLUMBING KIT TO REAR REMOTE VALVE (Figure 2)

ITEM	SMC NO.	DESCRIPTION	QTY.
1	31213-7	FITTING, Elbow, 45°, 3/4 x 3/4	4
2	47110-2	COUPLER, Female	4
3	6040-16	RETAINING RING, 1-1/2	8
4	51925	MID MOUNT COUPLING BRACKET	1
5	41838-26	SCREW, Cap, 5/16 x 3/4	4
6	41840-2	NUT, Lock, 5/16	4
7	34853-6	SLEEVE, Nylon, 1 3/4 x 40	1
8	4838-3	DUST CAP, Red	1
9	4838-8	DUST CAP, Blue	1
10	4838-9	DUST CAP, Yellow	1
11	4838-4	DUST PLUG, Red	1
12	4838-10	DUST CAP, Green	1
13	4838-13	DUST PLUG, Yellow	1
14	4838-14	DUST PLUG, Green	1
15	6137-13	COUPLER, Male	8
16	8137-3	STRAP, Adjustable, .50 x 20	2
17	8137-1	STRAP, Adjustable, .19 x 11	2
18	48311-1	HOSE, 1/2 x 59	4
19	48312-4	HOSE, 1/2 x 132	4
20	4838-12	DUST PLUG, Blue	1
21	7438-1	TIE STRAP	1
22	36240-1	SPIRAL BAND, .75, Blue	1
23	36240-2	SPIRAL BAND, .75, Red	1
24	36240-3	SPIRAL BAND, .75, Yellow	1
25	36240-4	SPIRAL BAND, .75, Green	1
26	34853-3	SLEEVE, Nylon, 1 3/4 ID x 60"	2

Figure 2
Two Function
Plumbing Kit
To Rear Remote Valve

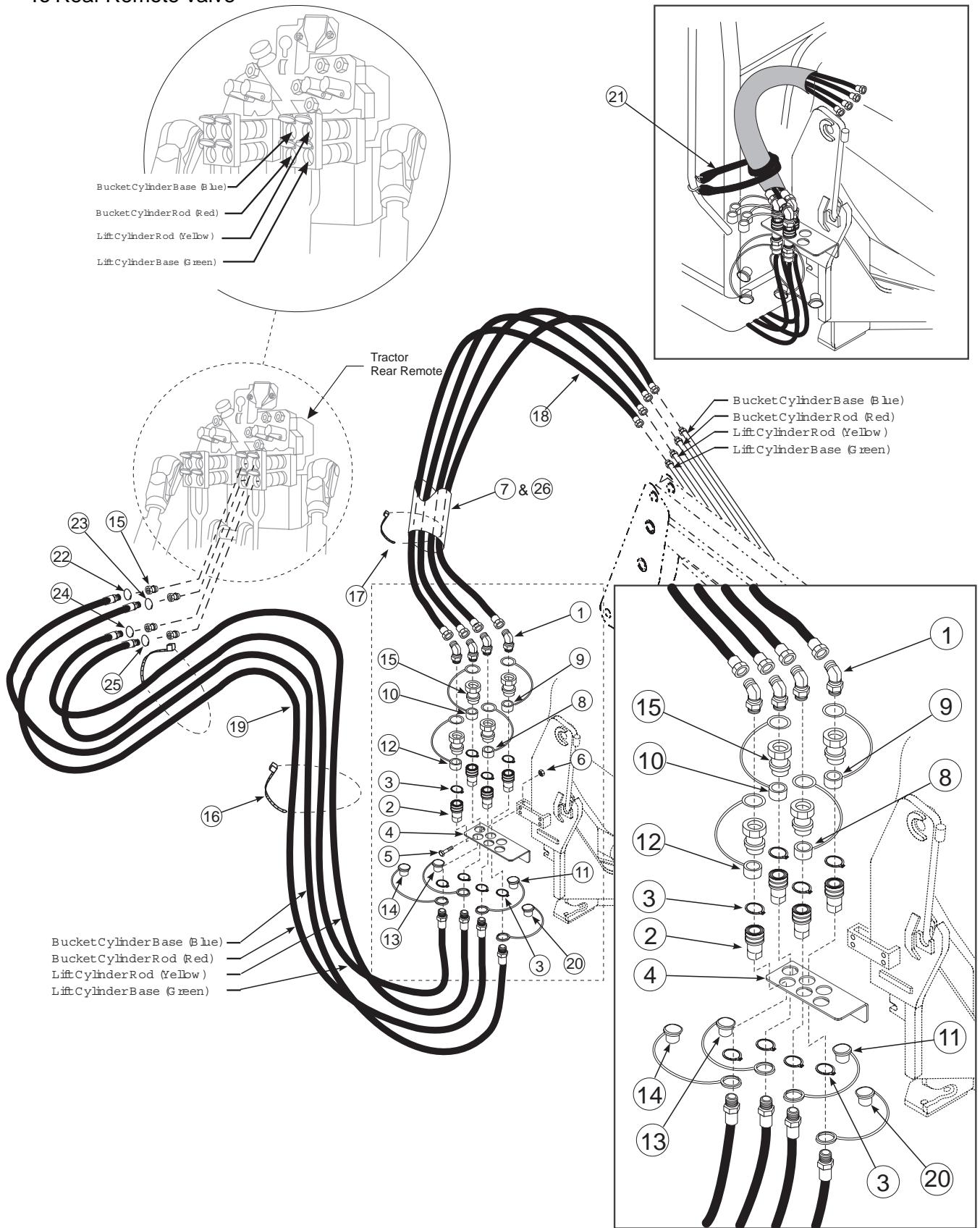

INSTALLATION INSTRUCTIONS