

Keep with Operators Manual

## GRILLE GUARD KUBOTA L4330, L4630, & L5030 TRACTORS COMPATIBLE WITH 2491 LOADER

### TRACTOR & GRILLE GUARD GENERAL INFORMATION

Grille guard can be installed using tools ordinarily available, including standard size wrenches.

Grille guard is designed to be compatible with 2491 loader. If front end loader is to be installed, install grille guard while installing loader front mounting bracket. Refer to instructions at right and instructions provided with loader mounting kit 2-7277.

### INSTALLING GRILLE GUARD (Figure 1)

**NOTE:** Install all attaching hardware loose until grille guard is completely assembled to facilitate assembly and proper alignment. Tighten all hardware to specified torques when assembly is complete.

1. If tractor is to be equipped with loader mounting kit 2-7277, install loader mounting brackets according to instructions provided with loader mounting kit, except do not install 14mm x 40mm cap screws provided with mounting kit into top holes of front mounting bracket. Instead use hardware provided with mounting kit in bottom holes only. Position grille guard (1) on top of loader front mounting bracket and fasten grille guard (1) and loader front mounting bracket to front of tractor frame using 14mm x 50mm cap screws (3) and lock washers (7) in top holes. Do not use spacer (2). (Thickness of loader front mounting bracket equals thickness of spacer.) Fasten grille guard (1) to sides of tractor frame using 1/2 x 2 cap screws (4), flat washers (6), and lock nuts (5).

If tractor is not to be equipped with loader mounting kit 2-7277, fasten grille guard (1) to sides of tractor frame using 1/2 x 2" cap screws (4), flat washers (6), and lock nuts (5). Place spacer (2) in position against front of tractor frame and rotate grille guard (1) into position. Fasten grille guard (1) and spacer (2) to front of tractor frame using 14mm x 50mm cap screws (3) and lock washers (7).

2. Torque 1/2 x 2" cap screws (4) and 1/2 lock nuts to 86-96 ft·lbs (116-130 N·m). Torque 14mm x 50mm cap screws to 85-103 ft·lbs (115-139 N·m).

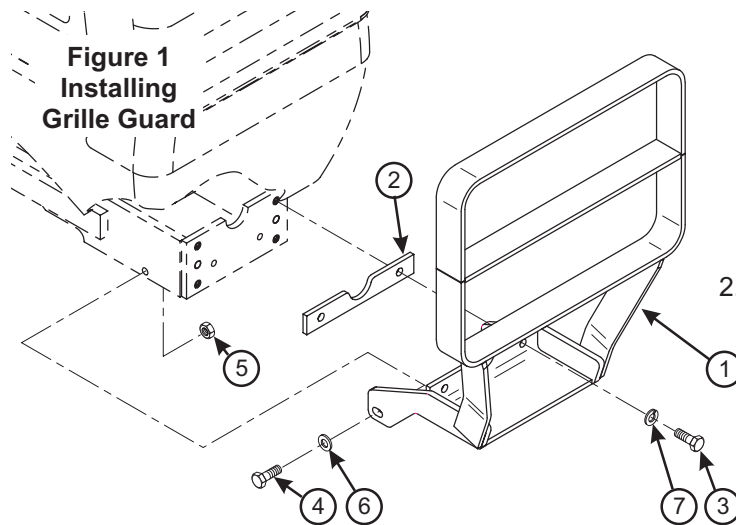

**NOTE:** Do not use spacer (2) if tractor is to be equipped with front end loader. Loader front mounting bracket takes the place of spacer (2) and 14mm x 50mm cap screws (3) are to be used in top pair of holes instead of 14mm x 40mm cap screws provided with loader mounting kit.

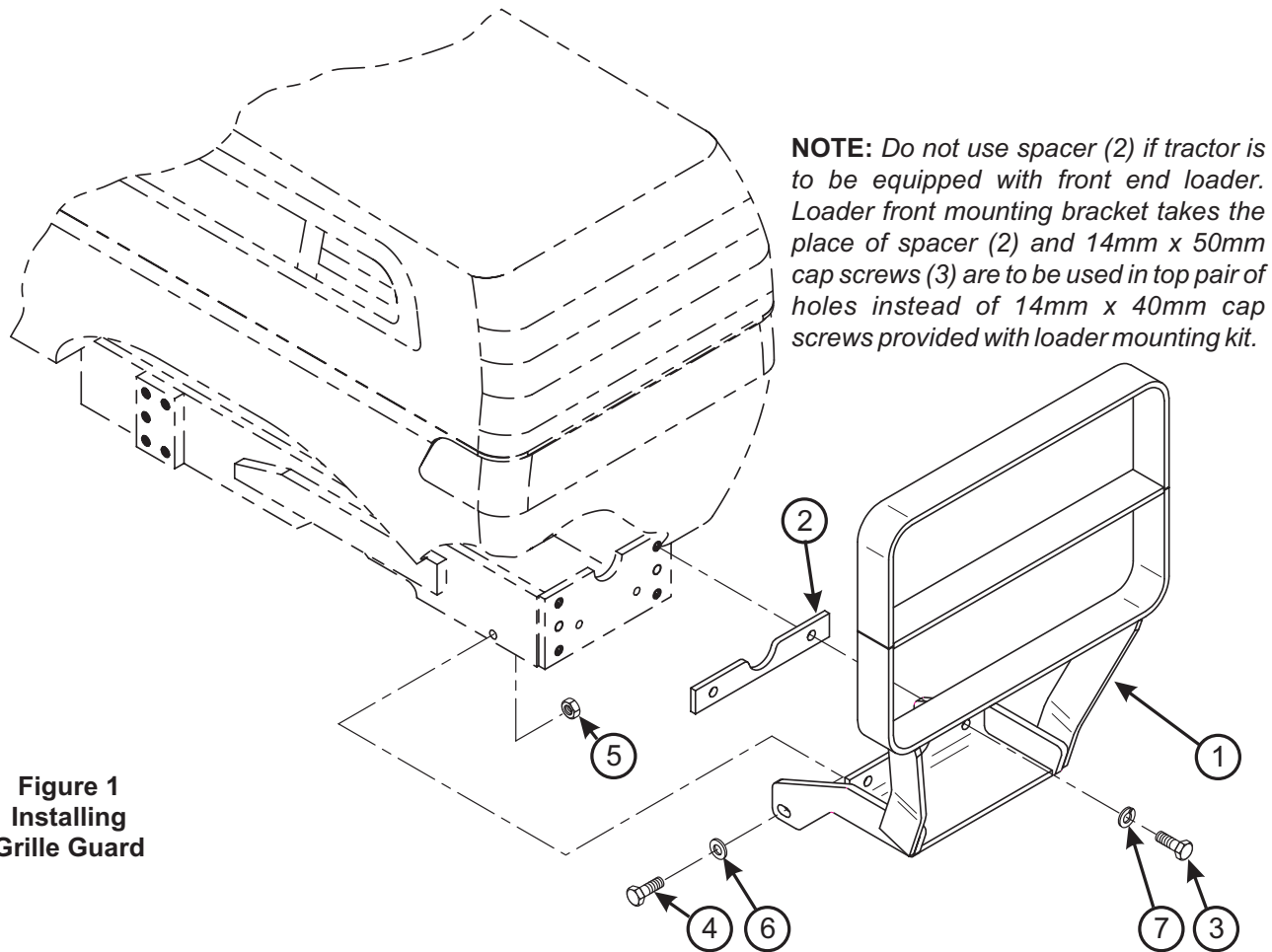

**Figure 1**  
Installing  
Grille Guard

#### PARTS LIST — GRILLE GUARD

Item	Part No.	Description	Qty.
1	51235	GRILLE GUARD	1
2	50928	SPACER PLATE	1
3	42672-58	SCREW, Cap, 14mm-1.50 x 50	2
4	41838-13	SCREW, Cap, 1/2-13 x 2"	2
5	41840-5	NUT, Lock, 1/2-13	2
6	42502-10	WASHER, Flat, 1/2	2
7	41837-6	WASHER, Lock, 9/16	2

# INSTALLATION INSTRUCTIONS