

Keep With Loader Operator's Manual

QUICK ATTACH BALE SPEAR

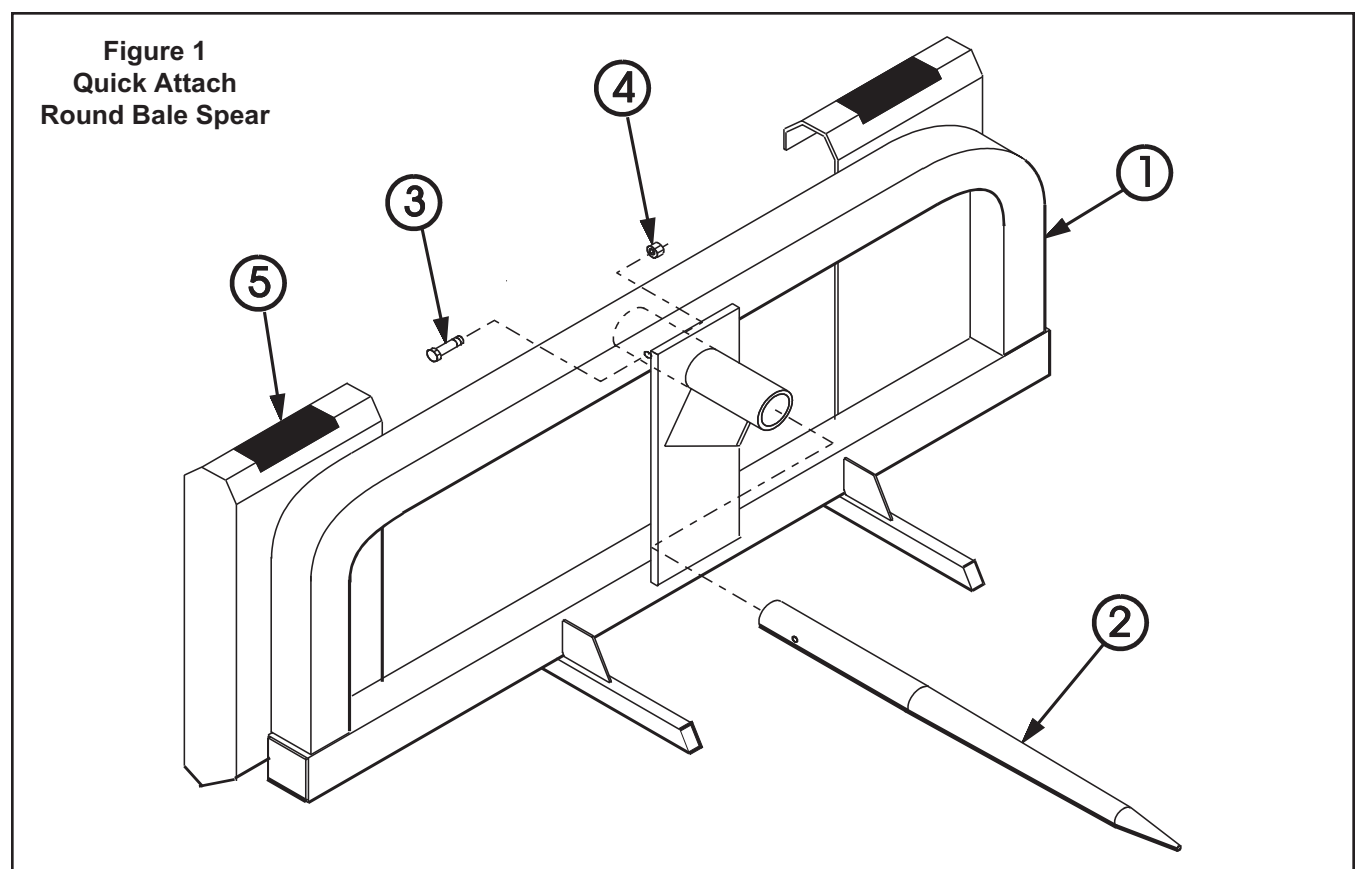

Bale spear can be assembled using tools ordinarily available.

ASSEMBLING ROUND BALE SPEAR (Figure 1)

1. Remove banding which secures bale spike (2) to bale spear attachment bracket (1). Temporarily remove 1/2 x 3-1/4 cap screw (3) and lock nut (4).

2. Place bale spike (2) into sleeve of bale spear bracket (1). Fasten spike to bracket using 1/2 x 3-1/4 cap screw (3) and lock nut (4).



WARNING: Keep bales, bale spear and loader boom clear of overhead lines. Allowing loader boom or any attachment to contact overhead lines may electrify entire tractor and Kill (electrocute) operator.

PARTS LIST - MOUNTING KIT

Item	SMC No.	Case IH No.	NH No.	Description	Qty.
1	*	*	*	BRACKET, Round Bale Spear	1
2	40906	SML40906	SML40906	SPIKE, Round Bale Spear	1
3	41838-1	413-852	88043	SCREW, Cap, 1/2-13 x 3-1/4	1
4	41840-5	231-4148	9636698	NUT, Lock, 1/2-13	1
5	25820-4	SML258204	SML258204	STEP, Anti Slip	2

*Not sold as separate repair item.

ATTACHING QUICK ATTACH BALE SPEAR

No tools are needed to install quick attach bale spear.



WARNING: To avoid injury during installation or removal of bale spear, do not allow bystanders within 10 feet of loader or bale spear.

1. Locate tractor and bale spear on firm, level ground. Lower boom to rest on the ground. Extend tilt cylinders slightly, while raising the boom to provide three to five inches of ground clearance.
2. Set tractor parking brake and shut off engine. Disengage latch pins by lifting handles and pulling them rearward, so latch pins are held in raised position.

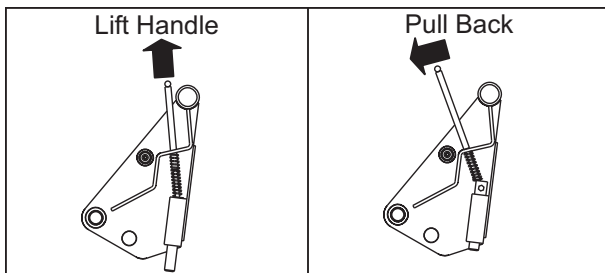

3. Making sure cross tube of quick attach bracket is parallel to bale spear frame, drive tractor ahead very slowly toward bale spear until cross tube touches bale spear just below attachment channel.
4. Lift loader booms slightly to engage cross tube in attachment channel, while simultaneously retracting tilt cylinders to roll bale spear back, tripping handles so latch pins engage.
5. Tilt bale spear at a slight downward angle so quick attach mechanism is visible. Rest bale spear on ground, set tractor parking brake, and shut off engine. Visually inspect quick attach mechanism to verify that pins are fully engaged in attachment ears.

NOTE: If bale spear is not securely attached, follow instructions for detaching it and repeat above procedure.

DISMOUNTING QUICK ATTACH BALE SPEAR



WARNING: Loader must be equipped with a heavy attachment such as a bucket when it is removed from tractor. Bale spear, pallet fork, or similar attachments are too light to safely counterbalance loader boom arms when loader is dismounted from tractor.



WARNING: To avoid injury during installation or removal of bale spear, do not allow bystanders within 10 feet of loader or bale spear.

1. Locate tractor and loader on level ground.
2. Lower boom arms until attachment is level and resting on ground. Shut off tractor engine and set tractor brakes.
3. Disengage latch pins by lifting handles and pulling them rearward, so latch pins are held in raised position.

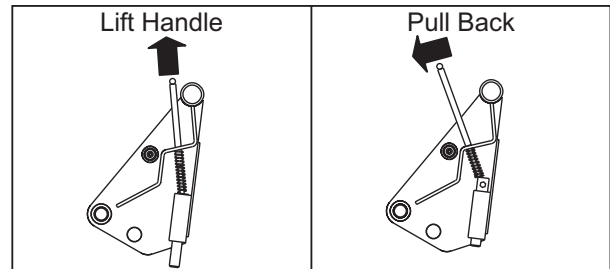

4. Start tractor engine, release brake and extend tilt cylinders while slowly backing tractor away from bale spear, until quick attach disengages from bale spear.

INSTALLATION INSTRUCTIONS