

SML26912 60"
 SML26913 72"
 SML26914 84"
 SML26842 96"

ASSEMBLY MANUAL

2-6624/2-6912
 2-6625/2-6913
 2-6626/2-6914
 2-6842

Keep With Operator's Manual

TOOTH BAR 60", 72", 84" & 96" HEAVY DUTY MATERIAL BUCKETS

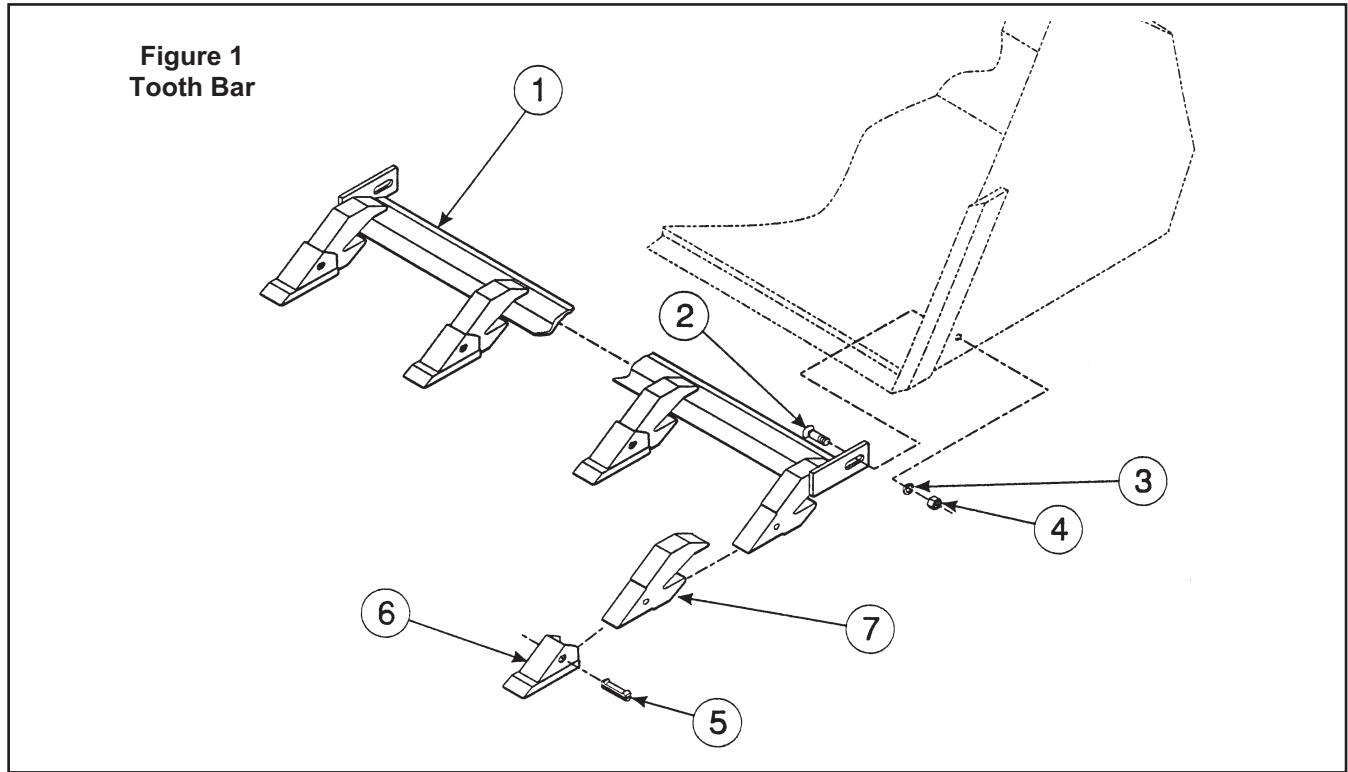

PARTS LIST - TOOTH BAR

Item	SMC No.	NH No.	CASE IH No	Description	Qty.
1	*	*	*	TOOTH BAR, Assembly	1
2	41839-1	280617	433-1024	BOLT, Carriage, 5/8-11 x 1-1/2	2
3	41837-1	86729275	492-11062	WASHER, Lock, 5/8	2
4	41836-7	280374	425-1010	NUT, Hex, 5/8-11	2
5	41562	D9NNA335AA	D9NNA335AA	PIN, Retaining	60" - 72" - 84" - 96" 7 - 7 - 8 - 9
6	41560	251472	251472	TOOTH	7 - 7 - 8 - 9
7	41561	SML41561DS	SML41561DS	SHANK, Tooth (Replacement)	as required

* Not sold as repair part.

NOTE: NOT COMPATIBLE WITH BOLT ON REVERSIBLE BLADE.

Tooth bar can be assembled using tools ordinarily available.

ASSEMBLING TOOTH BAR

1. Position tooth bar over cutting edge of bucket. Using end plates as a guide, mark and drill one 11/16" hole in each side of bucket.

NOTE: Make sure tooth bar is seated against cutting edge of bucket before marking and drilling holes. Drill holes near rear of slot so tooth bar can be adjusted rearward as cutting edge of bucket wears.

2. Fasten tooth bar to bucket using 5/8 x 1-1/2 carriage bolts (2), 5/8 lock washers (3) and 5/8 nuts (4).

2-6624/2-6912
2-6625/2-6913
2-6626/2-6914
2-6842

SML26912 60"
SML26913 72"
SML26914 84"
SML26842 96"

INSTALLATION INSTRUCTIONS