

Keep with Operators Manual

SMC 65, 75 & 85 BACKHOE MOUNTING KIT KUBOTA L2500, L2600 & L3000 TRACTORS

Reference to left and right used in this installation instruction sheet refer to position when seated in the operating position on backhoe.

Complete backhoe mounting requires subframe mounting kit 2-6801 and subframe channel kit (2-6509).

NOTE: Leave all attaching hardware loose until backhoe subframe is completely assembled to facilitate assembly and proper alignment. Torque hardware to torque specifications located in backhoe owner's manual.

IMPORTANT: Remove lynch pins and disconnect supports to disable 3-point hitch arms.

INSTALLING MOUNTING BRACKETS (Figure 3)

Tractor without 2408 loader mid-mounting.

1. Install front mounting bracket (1) to underside of transmission casting using 12mm x 30mm cap screws (7) and 1/2 lock washers (8).

Tractor with 2408 loader mid-mounting.

Remove and discard 4 bolts which secure loader mid-mount to underside of transmission. Install front mounting bracket (1) to underside of loader mid-mount using 12mm x 45mm cap screw (7) and 1/2 lock washers (8).

2. Remove and discard four bolts which secure bottom of tractor hitch to rear of tractor.

NOTE: Hitch will be held in place by two bolts at rear of tractor.

3. Install rear mounting bracket (2) to rear of tractor using 14mm x 45mm cap screws (9) and 9/16 lock washers (10).

INSTALLING SUBFRAME (Figure 3)

1. Install front and rear crosstubes (3 & 4) to channels (18 & 19) using 1/2 x 1-1/4 cap screws (11) and 1/2 lock nuts (12).

NOTE: Install front and rear crosstubes (3 & 4) in forward most set of holes in subframe channels (18 & 19).

2. Install subframe assembly to backhoe mainframe using 7/8 x 3 cap screws (15), 7/8 lock washers (17) and 7/8 nuts (16) in rear holes and 3/4 x 2 cap screws (13) and 3/4 lock nuts (14) in front holes.
3. On 65 backhoe install support braces (20) in front set of holes on subframe channels (18 & 19). On 75 & 85 backhoes install support braces (20) in rear set of holes on subframe channels (18 & 19) (See figures 1 & 3). Secure with 3/4 x 2-3/4 cap screws (21) and 3/4 lock nuts (22). Secure remaining end of support braces (20) to backhoe mainframe using 3/4 x 2-3/4 cap screws (21) and 3/4 lock nuts (22).

NOTE: Double nut cap screw (21) after torquing first nut to 350 Ft. Lbs.

MOUNTING BACKHOE TO TRACTOR

1. Back tractor over subframe close enough to connect to backhoe hydraulic system.
2. Using backhoe hydraulic controls, extend stabilizer cylinders and boom cylinder until rear crosstube (4) is level with rear mounting bracket (2) and front of subframe is on ground (Figure 1).
3. Slowly back tractor until rear crosstube (4) is seated in rear mounting bracket (2).
4. Retract boom cylinder and stabilizer cylinders so front of subframe swings up until front crosstube (3) is seated in front mounting bracket (1) (See figure 2).
5. Secure front crosstube (3) in place using clevis pins (5) and lynch pins (6).

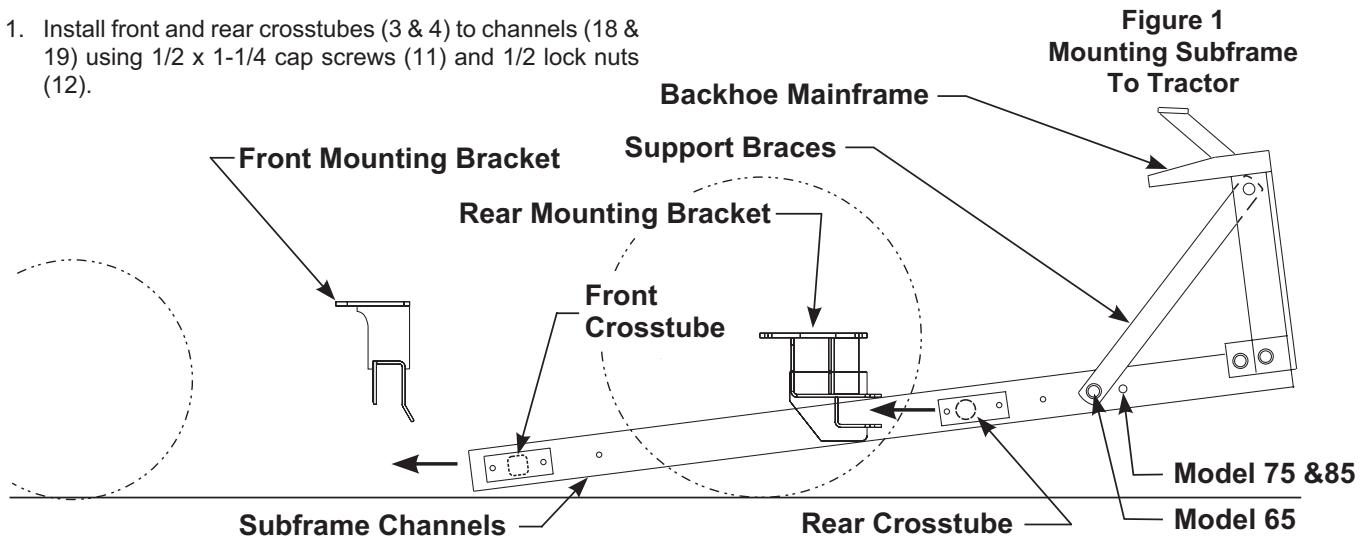

2-6801

Figure 2
Mounting Subframe
To Tractor

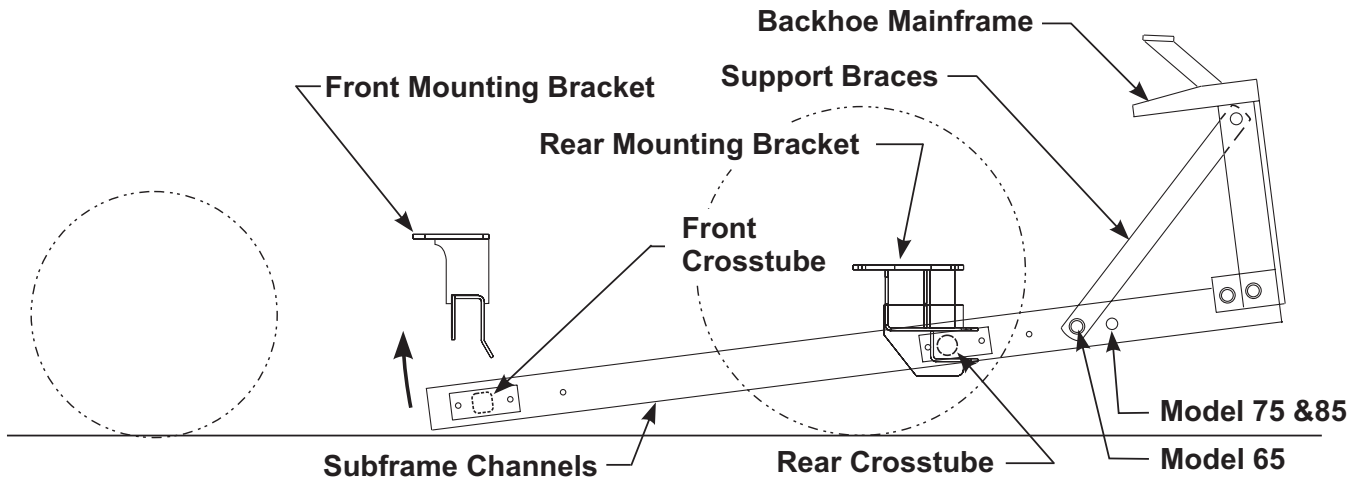

PARTS LIST - SUBFRAME MOUNTING KIT

| ITEM | PART NO. | DESCRIPTION | QTY. |
|------|----------|---|------|
| 1 | 49033 | MOUNTING BRACKET ASSEMBLY, Front | 1 |
| 2 | 49030 | MOUNTING BRACKET ASSEMBLY, Rear | 1 |
| 3 | 46318 | FRONT CROSSTUBE ASSEMBLY | 1 |
| 4 | 45710 | REAR CROSSTUBE ASSEMBLY | 1 |
| 5 | 44892 | PIN ASSEMBLY | 2 |
| 6 | 44756-1 | LINCH PIN | 2 |
| 7 | 6090-25 | SCREW, Cap, 12mm-1.25 x 30mm, Class 8.8 (use <i>without</i> loader mid-mount) | 4 |
| | 6090-83 | SCREW, Cap, 12mm-1.25 x 45mm, Class 8.8 (use <i>with</i> loader mid-mount) | 4 |
| 8 | G120384 | WASHER, Lock, 1/2 | 4 |
| 9 | 6090-3 | SCREW, Cap, 14mm-1.5 x 45mm, Class 8.8 | 4 |
| 10 | G120898 | WASHER, Lock, 9/16 | 4 |
| 11 | G180175 | SCREW, Cap, 1/2-13 x 1-1/4 | 8 |
| 12 | G9414074 | NUT, Lock, 1/2-13 | 8 |
| 13 | G271771 | SCREW, Cap, 3/4-10 x 2 | 2 |
| 14 | G9414076 | NUT, Lock, 3/4-10 | 2 |
| 15 | G271819 | SCREW, Cap, 7/8-9 x 3 | 2 |
| 16 | G220087 | NUT, 7/8-9 | 2 |
| 17 | G131047 | WASHER, Lock, 7/8 | 2 |

PARTS LIST - SUBFRAME CHANNEL KIT - 2-6509 - Order Separately

| ITEM | PART NO. | DESCRIPTION | QTY. |
|------|----------|-------------------------------------|------|
| 18 | 45700-1 | CHANNEL, Left | 1 |
| 19 | 45700-2 | CHANNEL, Right | 1 |
| 20 | 44836 | SUPPORT BRACE | 2 |
| 21 | G221135 | SCREW, Cap, 3/4-10 x 2-3/4, Grade 8 | 4 |
| 22 | 47264-8 | NUT, Lock, 3/4-10 | 8 |

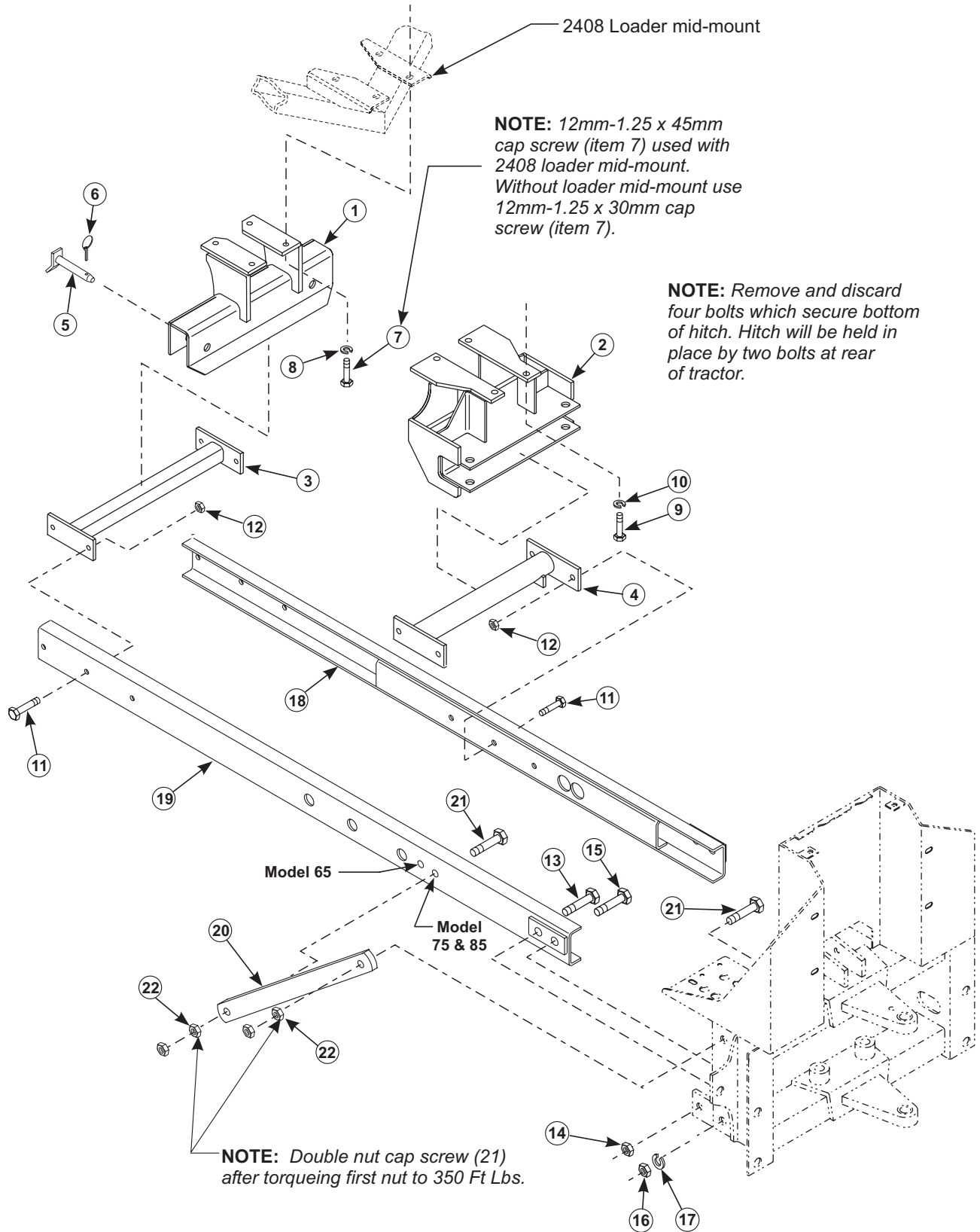

Figure 3
Subframe Mounting Kit