

Keep With Operator's Manual

756C, 757C & 758C BACKHOE HYDRAULIC KIT NEW HOLLAND TC35, TC40 & TC45 TRACTORS

Hydraulic kit can be installed on tractor and backhoe using tools ordinarily available. Tractor must be equipped with loader to operate backhoe.

INSTALLING HYDRAULIC KIT (Figure 1 & 2)

1. Remove plug from tank port on remote valve cover plate on right side using 8mm or 5/16" allen wrench. Install 1/2 x 3/8 elbow fitting (12), 1/2 x 15 hose (18) then 1/2 dust cap (6) and 1/2 male quick coupler (8) to tank port. Point fittings slightly downward to avoid tractor valve linkage.

On tractors not equipped with triple rear remotes, there is enough room to solid mount tank port coupler (8). Replace 1/2 x 15 hose (18) and elbow fitting (12) with elbow fitting 1/2 x 3/8 (2).

2. Remove backhoe cover plate. Install 3/8 x 120 (19) hose to inlet port on backhoe valve. Route hose inside right rail for protection. Install 3/8 male quick coupler (4) to end of 3/8 x 120 hose (19). Clamp this hose to inside of subframe using clamp (14), 5/16 x 1 cap screw (15), flat washers (17) and lock nut (7).
3. Install 1/2 x 72 hose (21) to tank port on backhoe valve (Figure 2). Install 1/2 inch female quick coupler (7) to end of 1/2 x 72 hose (21). Reinstall backhoe valve cover plate.
4. Route hoses (19 & 21) under backhoe footrest and along inside of subframe channels. Secure hoses under footrest using 11 inch tie strap (10).
5. Remove control valve cover and knob on tractor loader valve. Remove steel oil line between tractor remote valve power beyond port and tractor manifold power beyond port "A". Remove fitting at manifold. If line from power beyond port on valve to manifold is already a hose, do not remove it. Use in place of 30" hose (20).
6. Install 3/8 x 90° elbow (3), 3/8 adapter fitting (1), 3/8 dust cap (9) and 3/8 male quick coupler (4) to power beyond port "A" of hydraulic manifold. It may be necessary to loosen and readjust steel lines for clearance.

7. Remove adapter from power beyond port of tractor control valve and replace with new adapter (22). Install 1/2 x 30 hose (20) to new adapter. Route hose through floorboard cutout. Reinstall control valve cover and knob onto control valve. Install 3/8 female quick coupler (5) to end of 1/2 x 30 hose (20). Install fittings so 1/2 x 30 hose can be connected to manifold without being twisted. Couple hose from remote valve to manifold.

MOUNTING BACKHOE TO TRACTOR

1. Adjust 3-point lift arms to level position. Back tractor slowly toward backhoe, parallel to subframe assembly, until hoses can be connected to tractor.

IMPORTANT: Shut off tractor.



WARNING: To prevent possible damage to hoses and backhoe valve, always shut off tractor engine when coupling or uncoupling hoses from backhoe. Make sure connections are complete at couplers.

2. Connect tank hose (21) to tractor tank port. Disconnect pressure hose (20) from tractor manifold. Connect pressure hose (19) to power beyond hose (20)(from tractor remote valve).
3. Using backhoe controls, extend bucket and lower stabilizers to provide a base for raising subframe. Using backhoe controls, raise subframe to proper height to connect to tractor.
4. Slowly back tractor until subframe is engaged in rear mounting bracket and front mounting brackets.

NOTE: Check to be sure hoses are not pinched between tractor and subframe.

Connect subframe to front mounting brackets using pins provided in subframe kit.

5. Secure hose (19 & 20) to subframe using tarp strap (11). Make sure hoses are secure and will not rub on ground or tires.

6. After backhoe has been mounted to tractor, check all hydraulic connections. Slowly cycle backhoe cylinders several times to purge air from hydraulic system. Retract cylinders and shut off engine. Replenish tractor hydraulic system.



WARNING: Escaping hydraulic fluid under pressure can penetrate skin causing serious injury. If any fluid is injected into skin, obtain medical attention immediately or gangrene may result.

- DO NOT use your hands to check for leaks. Use a piece of cardboard or paper to search for leaks.
- Stop engine and relieve pressure before connecting or disconnecting lines.
- Tighten all connections before starting engine or pressurizing lines.
- Make sure hoses are secure and will not rub on ground or tires.

PARTS LIST - REPAIR PARTS

ITEM	PART NO.	NH NO.	DESCRIPTION	QTY.
1	44982-1	SML4498021	FITTING, Adapter, 3/8 NPTF x 3/8 NPTF	1
2	34644-2	SML346442	FITTING, Elbow, 1/2 NPT x 3/8 NPT, 90°	1
3	7669	SML7669	FITTING, Elbow, 3/8 NPT x 3/8 NPT, 90°	1
4	6137-4	SML61374	QUICK COUPLER, Male, 3/8	2
5	6147-4	SML61474	QUICK COUPLER, Female, 3/8	1
6	4838-3	SML48383	DUSTCAP, 1/2	1
7	6147-8	SML61478	QUICK COUPLER, Female, 1/2	1
8	6137-6	SML61376	QUICK COUPLER, Male, 1/2	1
9	4838-5	SML48385	DUSTCAP, 3/8	1
10	8137-6	SML81376	STRAP, Adjustable Tie, 5/16 x 11	1
11	7438-1	SML74381	STRAP, Tarp	1
12	6006-8	SML60068	FITTING, Elbow, 3/8 x 1/2, 90°	1
13	45037-5	SML450375	TRIM, Plastic, 4"	2
14	8222-6	SML82226	TUBE CLAMP	1
15	G180081	87657	SCREW, Cap, 5/16-18 x 1-1/4	1
16	G9413447	87382	NUT, Lock, 5/16-18	1
17	G120393	80664	WASHER, Flat, 5/16	1
18	6007-2	SML60072	HOSE, .50 x 15	1
19	41262-2	SML412622	HOSE, .38 x 120	1
20	48589-1	SML485891	HOSE, .50 x 30	1
21	41053-4	SML410534	HOSE, .50 x 72	1
22	32844-17		FITTING, Adapter, SAE 37°(JIC) 7/8-14, SAE O-ring 3/4-16	1

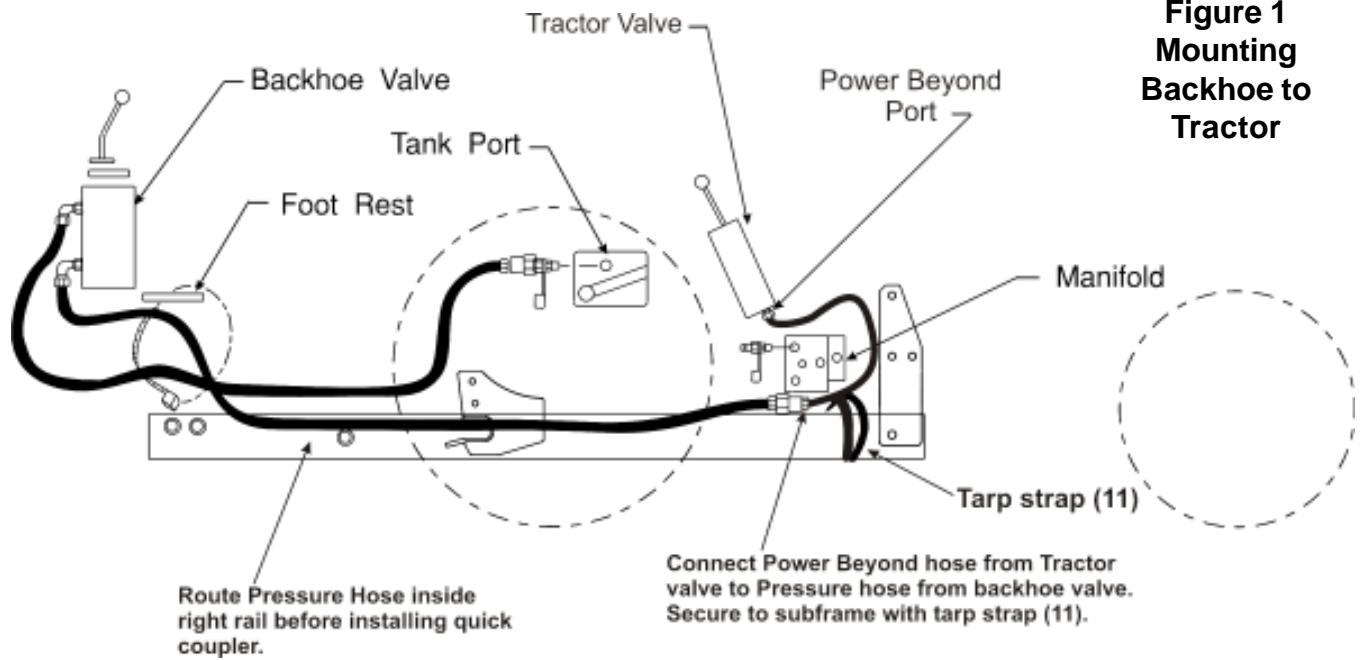

Figure 1
Mounting
Backhoe to
Tractor

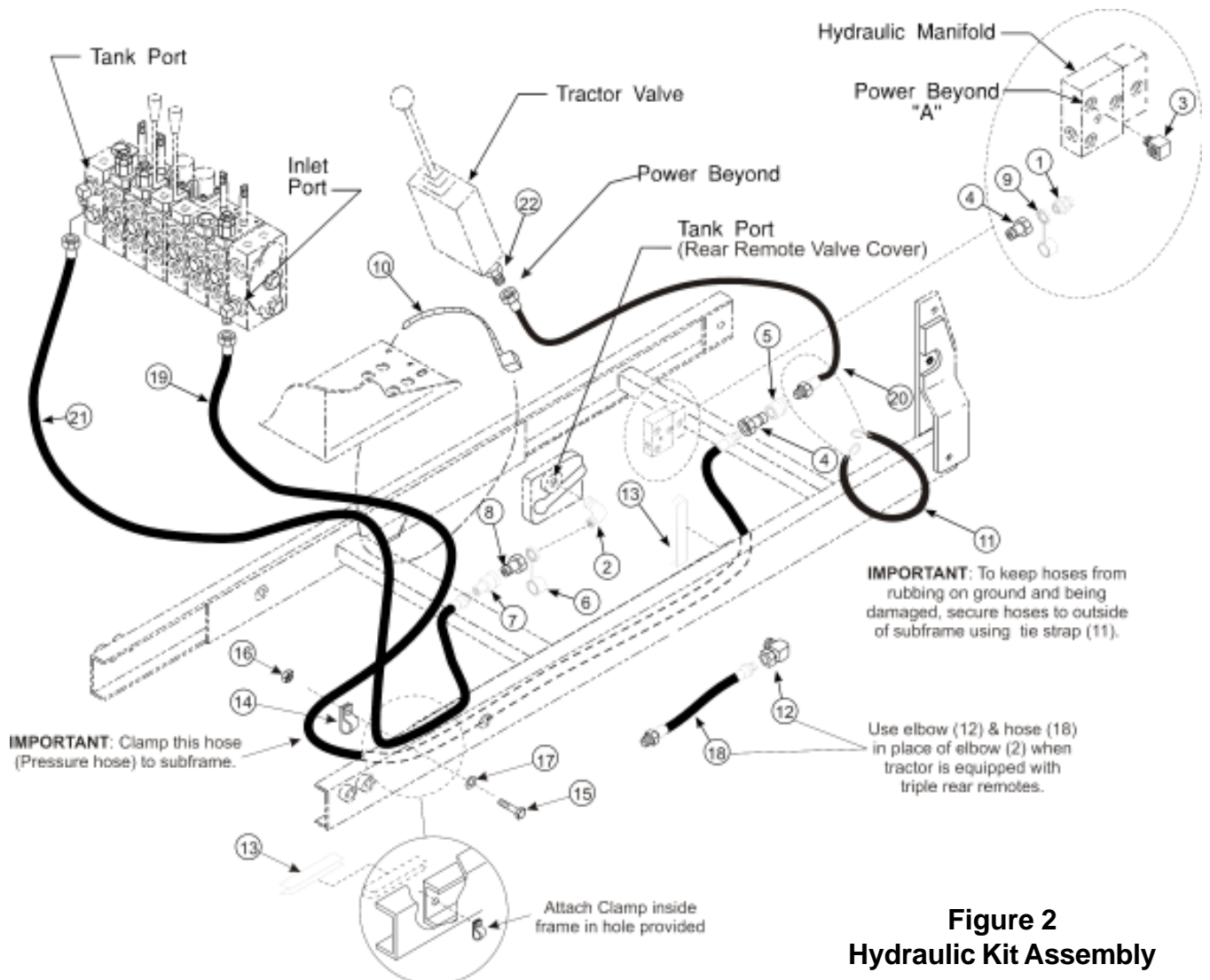



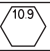



Figure 2
Hydraulic Kit Assembly

GENERAL TORQUE SPECIFICATIONS

USE THE FOLLOWING TORQUES WHEN SPECIAL TORQUES ARE NOT GIVEN

Standard American and Metric Cap Screws

AMERICAN STANDARD CAP SCREWS										METRIC CAP SCREWS							
SAE Grade	5				8				Metric Class	8.8				10.9			
Typ. Head Markings									Typ. Head Markings	 				 			
Cap Screw	TORQUE				TORQUE				Cap Screw	TORQUE				TORQUE			
Size	FT-LBS		N·m		FT-LBS		N·m		Size	FT-LBS		N·m		FT-LBS		N·m	
Inches	MIN	MAX	MIN	MAX	MIN	MAX	MIN	MAX	Millimeters	MIN	MAX	MIN	MAX	MIN	MAX	MIN	MAX
1/4 - 20	6.25	7.25	8.5	10	8.25	9.5	11	13	M6 x 1.00	6	8	8	11	9	11	12	15
1/4 - 28	8	9	11	12	10.5	12	14	16	M8 x 1.25	16	20	21.5	27	23	27	31	36.5
5/16 - 18	14	15	19	20	18.5	20	25	27	M10 x 1.50	29	35	39	47	42	52	57	70
5/16 - 24	17.5	19	23	26	23	25	31	34	M12 x 1.75	52	62	70	84	75	91	102	123
3/8 - 16	26	28	35	38	35	37	47.5	50	M14 x 2.00	85	103	115	139	120	146	163	198
3/8 - 24	31	34	42	46	41	45	55.5	61	M16 x 2.50	130	158	176	214	176	216	238	293
7/16 - 14	41	45	55.5	61	55	60	74.5	81	M18 x 2.50	172	210	233	284	240	294	325	398
7/16 - 20	51	55	69	74.5	68	75	92	102	M20 x 2.50	247	301	335	408	343	426	465	577
1/2 - 13	65	72	88	97.5	86	96	116	130	M22 x 2.50	332	404	450	547	472	576	639	780
1/2 - 20	76	84	103	114	102	112	138	152	M24 x 3.00	423	517	573	700	599	732	812	992
9/16 - 12	95	105	129	142	127	140	172	190	M27 x 3.00	637	779	863	1055	898	1098	1217	1488
9/16 - 18	111	123	150	167	148	164	200	222	M30 x 3.00	872	1066	1181	1444	1224	1496	1658	2027
5/8 - 11	126	139	171	188	168	185	228	251	<p>NOTE: These values apply to fasteners as received from supplier, dry or when lubricated with normal engine oil. They do not apply if special graphite or moly sulphide greases or other extreme lubricants are used.</p>								
5/8 - 18	152	168	206	228	203	224	275	304									
3/4 - 10	238	262	322	355	318	350	431	474									
3/4 - 16	274	305	371	409	365	402	495	544									
7/8 - 9	350	386	474	523	466	515	631	698									
7/8 - 14	407	448	551	607	543	597	736	809									
1 - 8	537	592	728	802	716	790	970	1070									
1 - 14	670	740	908	1003	894	987	1211	1337									

INSTALLATION INSTRUCTIONS