

Keep with Operator's Manual
-----------------------------

---

## THIRD FUNCTION HOSE KIT TO TRACTOR REAR REMOTE VALVES 5211, 46LB AND LX146 LOADERS

---

Plumbing kit can be installed using tools ordinarily available.

Shut off engine and engage brakes during installation.

### PLUMBING THIRD FUNCTION KIT TO REAR REMOTE VALVE (Figure 1)

1. Position the bulkhead assembly (1) on top of loader crossmember on rear side of hydraulic oil lines, 9" from where crossmember meets left side boom arm (see figure 1). Square with rear of crossmember. Using bracket (1) as template, drill two 7/32 holes into crossmember. Fasten bulkhead assembly bracket (1) to crossmember using 1/4 x 3/4 self tapping screws (2).
2. Assemble couplers (6 & 7) to bulkhead fittings (5) and fasten to bulkhead assembly (1) using nuts supplied with bulkhead union fittings (5). Assemble 90° adapter fitting (8) to bulkhead fitting (5) and attach female end of hoses (4) to 90° adapter fittings (8).
3. Install colored dust caps (9 & 10) to couplers (6 & 7) as illustrated in figure 1.
5. Route 3/8 x 264" hoses (4) from bulkhead assembly (1) to rear remote.
4. Install o-ring end of 90° fitting (16) and color coded dust caps (11 & 12) to male couplers (13). Install 3/4 JIC end of 90° fitting (16) to hoses (4). Attach colored spiral bands (14 & 15) and hoses (4) to corresponding female couplers on tractor rear remote.

**NOTE:** *It is important to make sure color coding corresponds between dust caps and spiral bands on each hose.*

6. Using adjustable plastic straps (3), bundle hoses together to avoid interference with moving parts.
7. After all plumbing has been completed slowly cycle third function attachment several times to purge air from hydraulic system. Retract cylinders and shut off engine. Replenish tractor hydraulic system.

**NOTE:** *When cycling third function, operate loader according to operation decal for valve. If direction of control lever is wrong, reverse hose connections and recheck operation.*



**WARNING:** *Escaping fluid under pressure can penetrate skin causing serious personal injury.*

- *Do not use your hands to check for leaks. Use a piece of cardboard or paper. Always wear eye protection when searching for leaks.*
- *Stop engine and relieve pressure before connecting and disconnecting lines.*
- *Tighten all connections before starting engine or pressurizing lines.*

*If any fluid is injected into skin, obtain medical attention immediately or gangrene may result.*

**Figure 1  
Third Function  
Plumbing Kit**

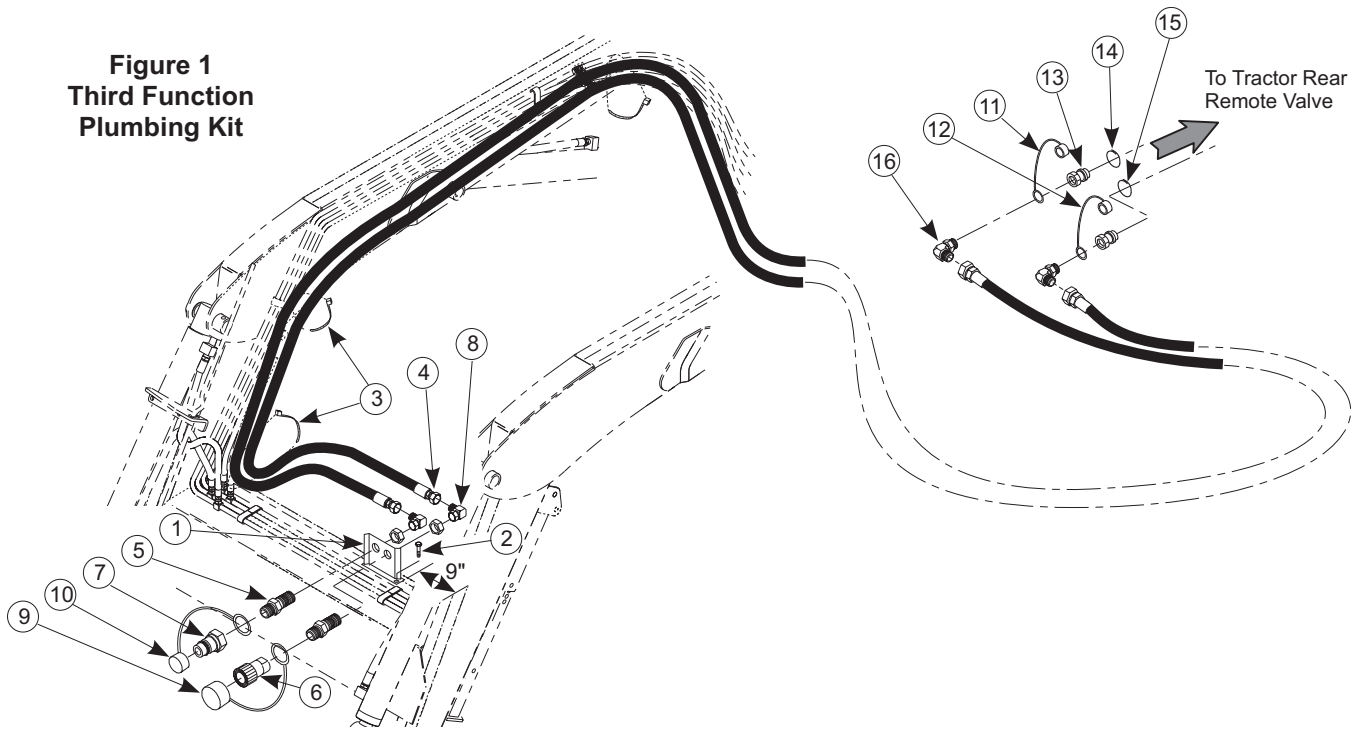

**PARTS LIST - THIRD FUNCTION PLUMBING KIT (Figure 1)**

Item	SMC No.	NH No.	CASE IH	Description	Qty.
1	47580	86582398	86582398	BULKHEAD ASSEMBLY	1
2	36354-2	88946	88946	SCREW, 1/4-14 x 3/4, Self tapping	2
3	8137-1	86582400	86582400	STRAP, Adjustable, .19 x 11	6
4	47422-3	SML474223	SML474223	HOSE, 3/8 x 264	2
5	47297-1	86582377	86582377	FITTING, Bulkhead Union, 3/4-16 O-ring x 3/4-16 JIC	2
6	45291-2	86582402	86582402	COUPLER, Flat face, Female	1
7	45292-2	86582403	86582403	COUPLER, Flat face, Male	1
8	34128-2	00248974	218-5230	FITTING, Elbow, 90°, 3/4-16 JIC x 3/4-16 JIC	2
9	4838-15	86582405	86582405	DUST CAP, 1-1/2" (for female coupler)	1
10	4838-16	86582406	86582406	DUST CAP, 1" (for male coupler)	1
11	4838-3	86581687	333721A1	DUST CAP, Red	1
12	4838-8	86581686	333717A1	DUST CAP, Blue	1
13	6137-10	86581680	86581680	COUPLER, Male	2
14	36240-10	86581691	86581691	SPIRAL BAND, Red, 1"	1
15	36240-9	86581690	86581690	SPIRAL BAND, Blue, 1"	1
16	32845-2	128830	218-5106	FITTING, Elbow, 90°, 3/4-16 O-ring x 3/4-16 JIC	2

# INSTALLATION INSTRUCTIONS