

Keep with Operator's Manual

3-POINT BRACKET KIT
MODEL 95 BACKHOE
MASSEY-FERGUSON 165, 175, 240 FWA, 253 FWA, 255,
265, 270, 275, 285, 298 & 362 TRACTORS

TRACTOR AND 3-POINT BRACKET KIT GENERAL INFORMATION

Three-point bracket kit can be installed using tools ordinarily available. Shut off tractor engine and engage parking brakes during installation.

MOUNTING BRACKET TO TRACTOR

NOTE: *Install all attaching hardware loosely (unless noted otherwise) until bracket is completely assembled to facilitate assembly and proper alignment.*

1. Unpin three-point upper link bracket from draft control link and rotate upper link bracket on lower pin downward and out of way.
2. Support tractor transmission casting and remove eight 1/2-13 cap screws (four each side as shown in figure 1) from flanges which fasten tractor axle trumpet casting to tractor transmission casting.

3. Slide three-point bracket (1) into position against tractor transmission and axle trumpet castings. Fasten three-point bracket (1) and trumpet casting using 1/2-13 x 2-1/4 cap screws (2) and lock washers (3) in locations where original fastening hardware was removed.
4. Fasten three-point bracket (1) to ears of tractor transmission casting using 3/4-10 x 4" cap screws (4) and hex nuts (5).
5. Tighten 1/2" hardware to 70 ft.·lbs. of torque. Tighten 3/4" hardware to 250 ft.·lbs. of torque.
6. When mounting backhoe, attach front center link to three point bracket using appropriate size bushings, 1.00 x 4-1/2" pin (6) and cotter pins (7).

FIGURE 1
3-Point Bracket Kit

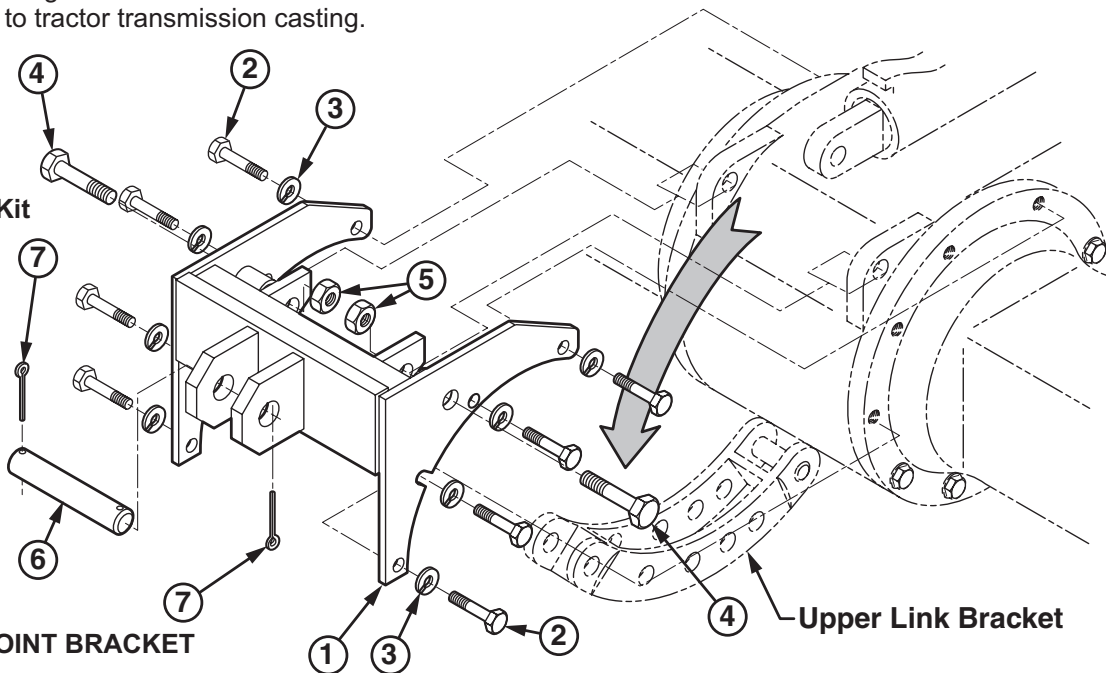

PARTS LIST – 3-POINT BRACKET

Item	Part No.	Description	Qty.
1	47360	BRACKET, 3-Point	1
2	41838-18	SCREW, Cap, 1/2-13 x 2-1/4" Grade 5	8
3	41837-5	WASHER, Lock, 1/2"	8
4	41838-71	SCREW, Cap, 3/4-10 x 4" Grade 5	2
5	41836-8	NUT, Hex, 3/4-10	2
6	44866-4	PIN, ϕ 1.00" x 4-1/2"	1
7	41903-9	PIN, Cotter, 3/16 x 2"	2

INSTALLATION INSTRUCTIONS