

PALLET FORK BOOM ATTACHMENT

INSTALLING BOOM ASSEMBLY

Boom assembly can be installed using tools normally available. Lower pallet fork to ground. Shut off tractor engine and engage brakes.

1. Install boom assembly to pallet fork frame using mounting shaft (3) and hair pin clips (5).
2. If pallet fork has rollback protector option, collapse boom and latch boom in upright position using pin assembly (6) through top of rollback protector and hair pin clip (5)(Figure 1).
3. If pallet fork does not have rollback protector option, collapse boom and latch boom in upright position using boom hanger (7), clevis pins (8) and hair pin clips (9).

OPERATION (Figure 2A)

1. Lower boom assembly onto pallet fork tines.
2. Remove latch pin (6) and extend inner boom assembly to desired length. Secure using latch pin (6) and hair pin clip (5).
3. Lift load using grab hook (4) or loop on end of boom.



CAUTION: Never exceed lift ratings shown on boom rating decal (11) or damage to pallet fork or serious injury may occur.

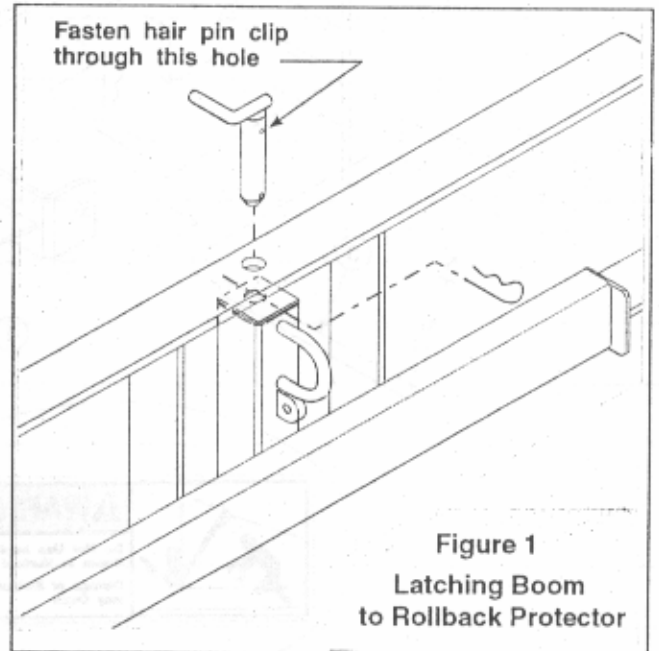

Figure 1
Latching Boom
to Rollback Protector



WARNING: Never use boom in vertical position. Damage or serious injury may occur.

PARTS LIST - BOOM ATTACHMENT

ITEM	PART NO.	DESCRIPTION	QTY.
1	43850	BOOM ASSEMBLY, Main	1
2	43855	BOOM ASSEMBLY, Inner	1
3	43861	SHAFT, Boom Mounting	1
4	43862-1	HOOK, Grab	1
5	41901-3	HAIR PIN, Clip	3
6	43860	PIN, Latch	1
7	43863	HANGER, Boom	1
8	41902-1	CLEVIS PIN	2
9	41901-1	HAIR PIN, Clip	2
10	43826	DECAL, Warning, Do not use...	1
11	43831	DECAL, Boom Rating	2

Figure 2
Boom Assembly

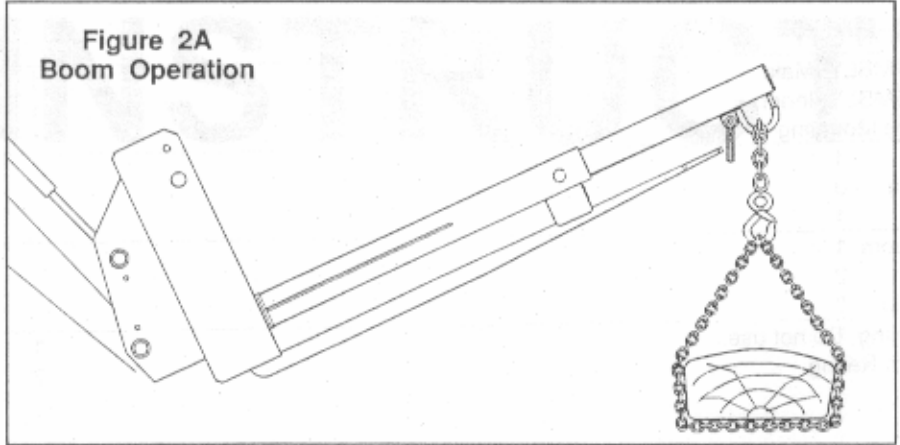
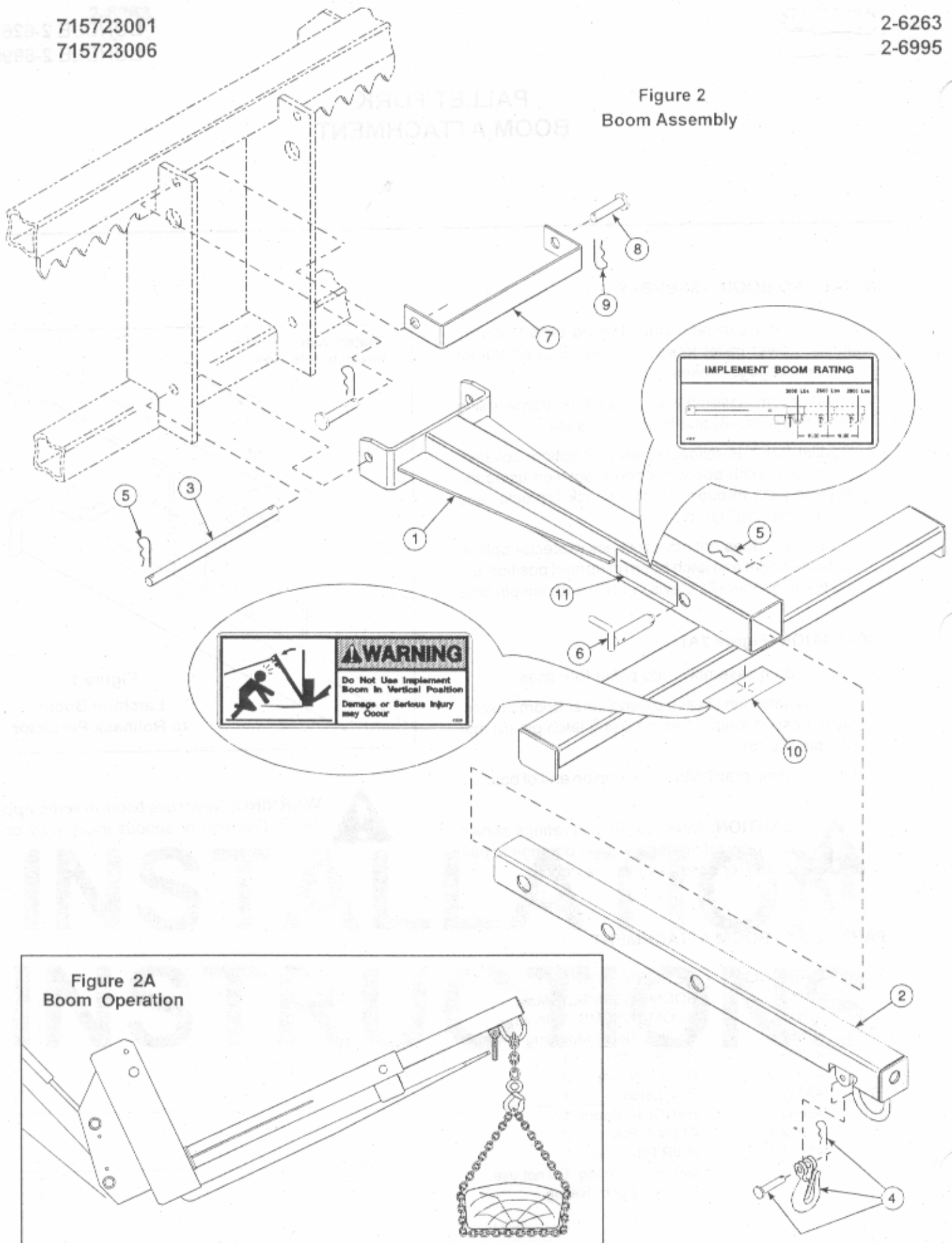

2-6263
2-6995

715723001
715723006

INSTALLATION INSTRUCTIONS