

2-5873
LOADER MOUNTING KIT INSTRUCTIONS FOR
KUBOTA L2050 2WD & 4WD & L2350 4WD TRACTORS
COMPATIBLE WITH ROPS MODEL L1170 (1-PIECE) OR SFL-20 (3-PIECE)

The mounting brackets can be installed on the tractor using tools ordinarily available. Shut off the tractor engine and engage tractor brakes during installation.

NOTE: Leave all attaching hardware loose until the loader is completely assembled to facilitate assembly and proper loader alignment. Tighten all hardware to the torques specified by the table in the loader operator's manual.

INSTALLING LOADER MOUNTING BRACKETS

1. Remove tractor front bumper and store it, along with attaching hardware, in case tractor will ever be used with loader brackets removed. Fasten loader front mounting bracket (1) to tractor front frame with M14 x 40 metric cap screws (8) and lock washers (12).
2. Fasten mid mounting bracket (2) to mounting pads on belly of tractor transmission casting using M12 x 30 metric cap screws (9), lock washers (13) and flat washers (15). Fasten mid mounting bracket (2) to left mounting pad on engine casting using M14 x 40 metric cap screws (8), lock washers (12) and flat washers (14). Place spacers (5) between mid mounting bracket (2) and right side of tractor engine casting. Fasten mid mounting bracket (2) and spacers (5) to right side of engine casting using M14 x 50 metric cap screws (7), lock washers (12) and flat washers (14).
3. Fasten left rear reinforcement bracket (3) to left side of mid mounting bracket (2) using 1/2 x 1-1/2 cap screws (11) and lock nuts (16). Fasten left rear reinforcement bracket (3) to ROPS bracket on tractor rear axle using 1/2 x 1-3/4 cap screws (10), flat washers (15) and lock nuts (16). Fasten right reinforcement bracket (4) to mid mounting bracket (2) using one 1/2 x 1-1/2 cap screws (11) and lock nut (16) at the frontmost overlapping hole (leave rear overlapping hole unused since it is provided for mounting loader control valve bracket). Fasten right reinforcement bracket (4) to right ROPS bracket using 1/2 x 1-3/4 cap screws (10), flat washers (15) and lock nuts (16).

NOTE: For tractors with 1-piece ROPS, rear reinforcement brackets (3 & 4) should be fastened to outside surfaces of ROPS brackets and plates of mid mounting bracket (2). For tractors with 3-piece ROPS, rear reinforcement brackets (3 & 4) should be fastened to inside surfaces of ROPS brackets and mid mounting bracket (2) plates. Use spacer (6) at upper hole in mid mounting bracket (2) when connecting loader control valve mounting bracket to mid mounting (2) and right rear reinforcement (4) on tractors with 1-piece ROPS.

INSTALLING LOADER TO MOUNTING BRACKETS

1. Attach nylon slings around the loader front bumper and use an overhead hoist to support loader while removing pallet attachment brackets from loader: remove 3/8 lock nuts and shoulder bolts securing flat brackets to loader and remove 3/4 lock nuts and carriage bolts securing angle brackets to loader, then remove pallet. Reinstall hardware to loader to secure pins and hinges.
2. Remove 5/8 x 2 -1/4 cap screws, washers and lock nuts so hinges can be opened. Lower loader to a horizontal position and attach nylon slings around the loader lift boom arms. Use the overhead hoist to raise the loader and position the side frame channels over the front mounting brackets. Slide the loader to the rear until side frames are on the tubes of mid mounting brackets.

NOTE: Lower lip of side frame channel must be between front mounting tubes. See next page.

INSTALLING LOADER TO MOUNTING BRACKETS (continued)

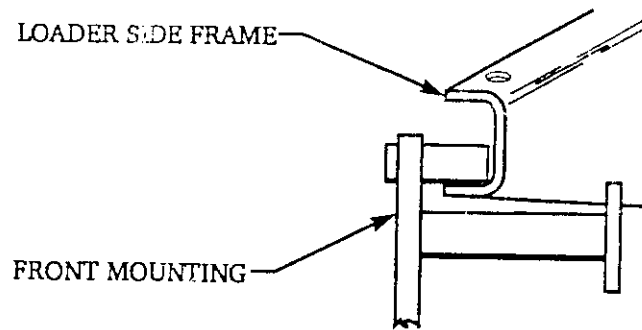

3. Clamp hinges around tubes of mid mounting brackets. Fasten with 5/8 x 2-1/4 cap screws, washers and lock nuts.
4. Refer to the loader operator's manual and instructions packed with valve and plumbing kit to complete loader installation.

PARTS LIST

Item	Part No.	Description	Qty.
1	38538	BRACKET, Front Mounting	1
2	38541	BRACKET, Mid Mounting	1
3	39894-1	BRACKET, Rear Reinforcement, Left	1
4	39894-2	BRACKET, Rear Reinforcement, Right (Not Shown)	1
5	14139	SPACER, Mid Mounting	2
6	39893	SPACER, Valve Bracket	1
7	6090-5	SCREW, Metric Cap, M14-1.5 x 50	2
8	6090-2	SCREW, Metric Cap, M14-1.5 x 40	6
9	6090-25	SCREW, Metric Cap, M12-1.25 x 30	4
10	G180179	SCREW, Cap, 1/2-13 x 1-3/4	4
11	G180177	SCREW, Cap, 1/2-13 x 1-1/2	3
12	G120898	WASHER, Lock, 9/16	8
13	G120384	WASHER, Lock, 1/2	4
14	G121458	WASHER, Flat, 9/16	4
15	G120396	WASHER, Flat, 1/2	8
16	G9414074	NUT, Lock, 1/2-13	7

NOTE: Location of rear reinforcement brackets (3 & 4) shown is for tractors equipped with 3-piece ROPS.

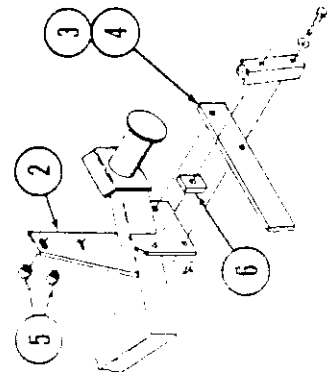
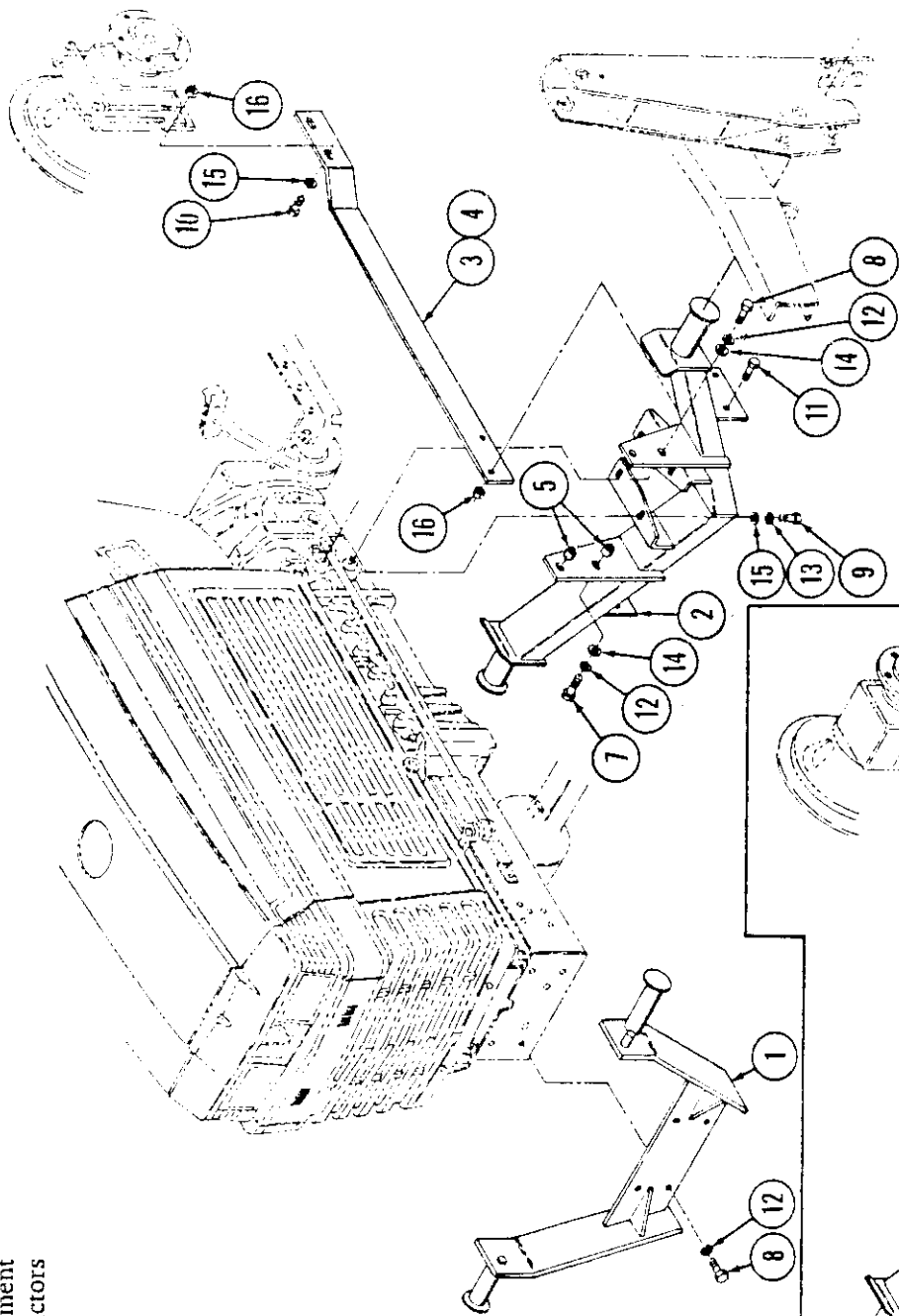

Attaching valve mounting bracket to mid mounting and rear reinforcement on tractors with 1-piece ROPS.

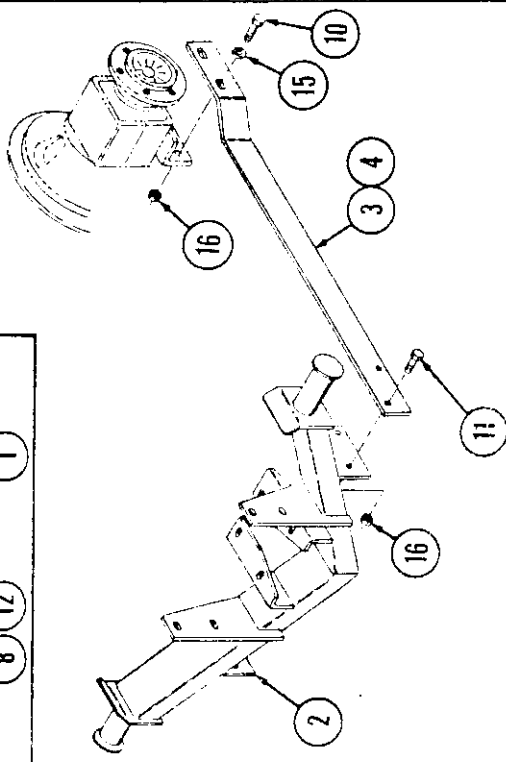

Attaching rear reinforcement brackets to mid mounting bracket on tractors with 1-piece ROPS.