

715805001

BUNDLE 2-5542

LOADER AUXILIARY 2-SPOOL VALVE & PLUMBING INSTRUCTIONS  
TRACTOR HYDRAULIC SYSTEM

The valve and plumbing can be installed on loader and tractor using tools ordinarily available. Shut off tractor engine and engage tractor brakes during the installation.

INSTALLING AUXILIARY VALVE (Figure 1)

1. Install nut (3) figure 1 and lock washer (4) onto valve handle (2). Install handle into handle adaptor of valve (1) and lock with nut.
2. Fasten guide tube (5) to the inside surface of guide flat on right side of mid mounting bracket using 1/2 x 1-1/2 carriage bolts (6) and lock nuts (7). Slide adjustable mounting bracket (8) inside of guide tube (5).
3. Fasten valve (1) to the valve mounting bracket (9) with 3/8 x 2" cap screws (10) and lock nuts (11). Slide valve bracket (9) into adjustable bracket (8) and secure with 3/8 x 2-1/2 cap screws (12) and lock nuts (11). The adjustable mounting bracket and valve bracket should be adjusted so the valve lever is conveniently located for the operator. Secure adjustable bracket (8) within guide tube (5) with 1/2 x 1" square head set screw (13). Excess tube on adjustable bracket (8) and valve bracket (9) may be cut off.

PLUMBING LOADER TO AUXILIARY VALVE (Figure 2)

1. Install 7/8 - 7/8 x 90° elbow adaptor fittings (14) into the four working ports of valve (1). Slide (4) 120" hoses (15) into 96" sleeve (21).
2. Install 1/2 x 120" hoses (15) connecting boom oil lines to elbow adaptor fittings (14) in the four working ports of valve.

PLUMBING AUXILIARY VALVE TO TRACTOR HYDRAULICS (Figure 2)

1. Install 7/8 - 1-1/16 elbow adaptor fittings (16) into the inlet and outlet ports of valve (1). Slide each 108" hose (17) into 72" sleeve (22).
2. Install 1/2 x 108" hoses (17) to elbow adaptor fittings (16) in inlet and outlet ports of valve and install male quick couplers (not supplied with loader) to other end of hoses. Route hoses over the tractor rear axle housing and plug couplers into tractor remote hydraulic couplers. Slide all sleeves (21 & 22) toward valve end of hoses until hose crimps are covered. Punch holes through sleeves (21 & 22) near each end of sleeve, using adjustable plastic straps (18). Secure sleeves to hoses by running strap through sleeves and around hoses to avoid slippage.



**WARNING:** When plugging couplers into tractor remote couplers, make sure they are connected to the same remote outlet. The line from inlet port of valve must be the line pressurized when tractor valve lever is engaged or damage to the valve could occur.

PLUMBING AUXILIARY VALVE TO TRACTOR HYDRAULICS (continued)

3. Wrap one end of rubber strap (19) around 1/2" hoses (15) and hook back onto rubber strap. Attach other end of rubber strap to a convenient place on loader or mounting bracket. See figure 3 for suggested locations.
4. The tractor valve lever must be engaged and placed in the detent position so there is continuous oil flow to the auxiliary valve. Tie or wire lever to hold it in the detent position.
5. Apply decal (20) figure 2A on rear side of right loader upright, centered, 6" from top.
6. After all plumbing is completed, start tractor engine and slowly cycle lift and bucket cylinders several times to free the system of air, then retract cylinders and stop engine. Add additional hydraulic oil, as specified in your tractor owner's manual, to bring oil level up to the full mark.

**NOTE:** When cycling the loader, pulling valve lever back should raise the loader and pushing it forward should lower the loader. Pulling valve lever to the left should roll back the bucket and pushing it to the right should dump the bucket. If direction of valve lever is reversed, recheck hose connections at auxiliary valve working ports against connections shown.



**WARNING:** Escaping hydraulic oil under pressure can have sufficient force to penetrate the skin causing serious personal injury. If injured by escaping oil, obtain medical treatment immediately.

PARTS LIST

Item	Part No.	Description	Qty.
1	35904	VALVE, Prince (2500 PSI)	1
2	36075	HANDLE, Valve	1
	36076	REPLACEMENT, Handle Knob	1
3	G271506	NUT, Hex, 7/16-20	1
4	G120383	WASHER, Lock, 7/16	1
5	36936	TUBE, Guide	1
6	G120917	BOLT, Carriage, 1/2-13 x 1-1/2	2
7	G9414074	NUT, Lock, 1/2-13	2
8	35543	BRACKET, Adjustable Mounting	1
9	35540	BRACKET, Valve Mounting	1
10	G180130	SCREW, Cap, 3/8-16 x 2"	3
11	G9413534	NUT, Lock, 3/8-16	5
12	G180134	SCREW, Cap, 3/8-16 x 2-1/2	2
13	G110450	SCREW, Set, Sq. Hd., 1/2-13 x 1"	2
14	32845-3	FITTING, Elbow, 7/8 - 7/8 x 90°	4
15	36698-4	HOSE, 1/2 x 120"	4
16	32845-4	FITTING, Elbow, 7/8 - 1-1/16 x 90°	2
17	36845-1	HOSE, 1/2 x 108"	2
18	8137-1	STRAP, Reusable Tie	8
19	7438-1	STRAP, Rubber	1
20	30797	DECAL, 1-Lever Valve Control	1
21	34853-19	SLEEVE, 96"	1
22	34853-19	SLEEVE, 72"	2

**Figure 1A**  
Mounting Bracket Locations  
For TWD Tractors

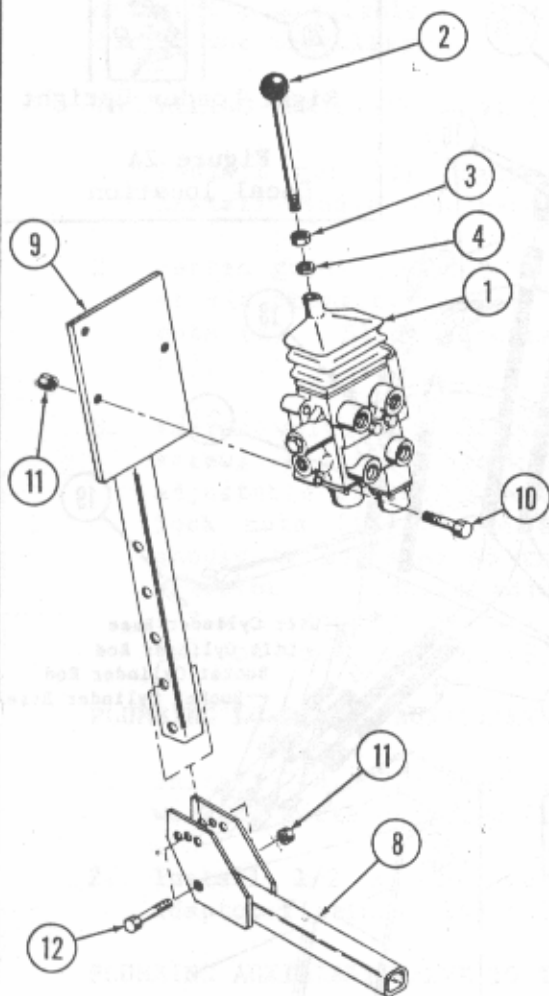

**Figure 1B**  
Mounting Bracket Location  
For FWA Tractors

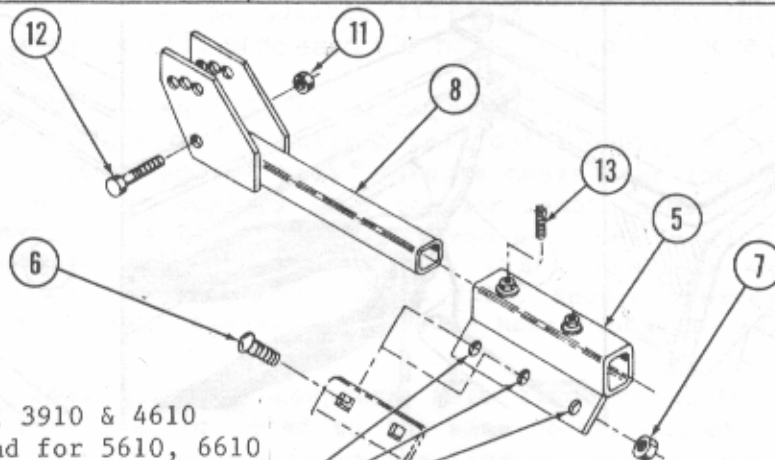
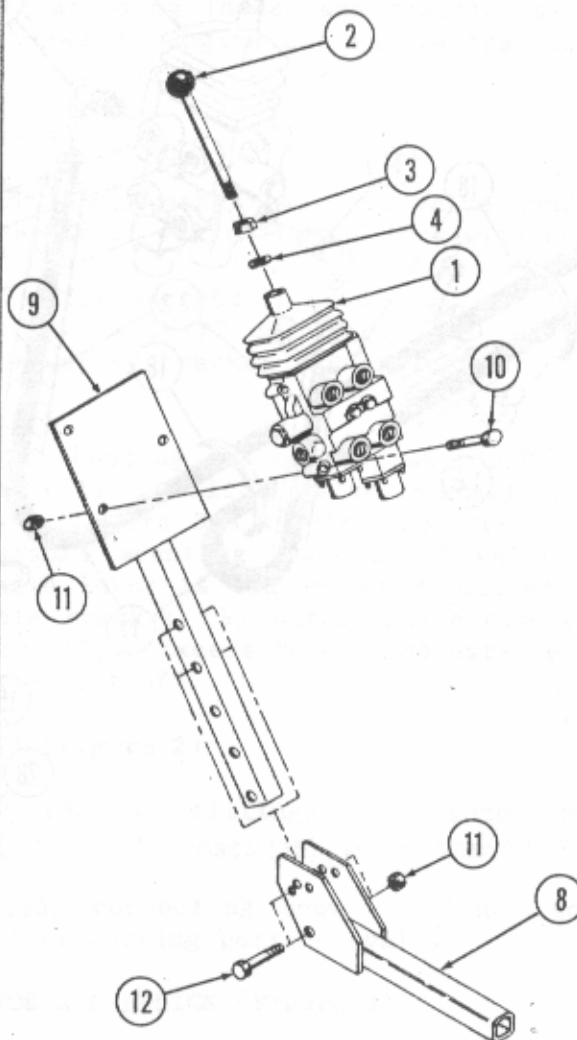

**NOTE:** For 2810, 2910, 3910 & 4610 TWD & FWA tractors, and for 5610, 6610 & 7610 TWD tractors, use rear pair of holes. For 5610, 6610 & 7610 FWA tractors, use front pair of holes.

